

nwfa expo

Ignite YOUR PASSION

APRIL 21-23, 2026 | ORLANDO



EXHIBITOR *Showcase* GUIDE

THE ONLY TRADE SHOW
IN THE WORLD DEDICATED
EXCLUSIVELY TO
Wood Flooring

Brought to you by:
hardwood floors

THE MAGAZINE OF THE NATIONAL WOOD FLOORING ASSOCIATION



LEARN MORE AT NWFAEXPO.ORG

OldeWood

L I M I T E D

VISIT US AT EXPO
BOOTH #501

LUXURY WIDE PLANK FLOORING

SOLID • ENGINEERED • UNFINISHED • PREFINISHED

MANUFACTURED IN AMERICA



866-208-9663 | OldeWoodLtd.com



PALLMANN®

WOOD FLOORS. PROTECTED.

SUBFLOOR PERFORMANCE SYSTEMS

**INSTALL WITH STRENGTH
AND CONFIDENCE**

SCAN HERE





TO LEARN MORE



BOOTH #1301

US.PALLMANN.NET

  pallmannusa

UZIN UTZ®

WOODWISE®

PROFESSIONAL HARDWOOD FLOORING PRODUCTS



Come By and Say Hi at Booth 1101!

THE RIGHT WOOD FILLERS FOR EVERY JOB.



Trusted by flooring professionals throughout North America, **WOODWISE** wood fillers are the gold standard for hardwood flooring applications and are supported by a full line of wood care products, tools and accessories.

+ WOOD CARE PRODUCTS



& TOOLS & ACCESSORIES



To learn more or find a dealer near you, go to woodwise.com or call us at **425-869-0859**.

. WORK WISELY .
with

WOODWISE®

Design Hardwood Products, Inc. • Redmond, WA





CONTENTS

Chair's Welcome	10
NWFA Expo Sponsors	12
NWFA Expo App and Wi-Fi Instructions	14
Expo Schedule	16
Expo Exhibitor List by Name	24
Expo Exhibitor List by Product Category	32
Expo Exhibitor Showcase	46
Trade Show Floor Plan	64
Sightseeing in the Sunshine State	66
Ad Index	68

nwfa expo

'26

Ignite YOUR PASSION

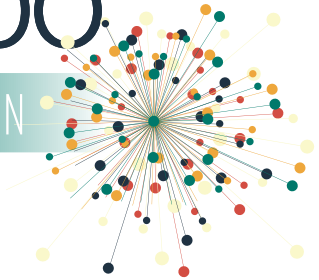

THANK YOU TO OUR PUBLISHING PARTNERS





CORUS

Your Complete Flooring Supply Partner.

Fasteners Tools Cordless Adhesives
Sawblades Strapping more

One order. One shipment. Nationwide reach.



800-255-7209



corusfastening.com

VISIT US AT BOOTH

#901



Benefits of using **The Bona System**[®]

- Training and educational opportunities available
- Responsive technical support when needed
- Solutions for every flooring need
- Support for the lifetime of the floor
- Strong homeowner brand awareness of Bona



SCAN TO
Learn More
About Every
Step of The
Bona System!

Bona.com



Bona[®]



COMMERCIAL | RESIDENTIAL

COATINGS

PROFESSIONAL POLYURETHANE



SCAN HERE



LEARN MORE



GAMETIMECOATINGS.COM

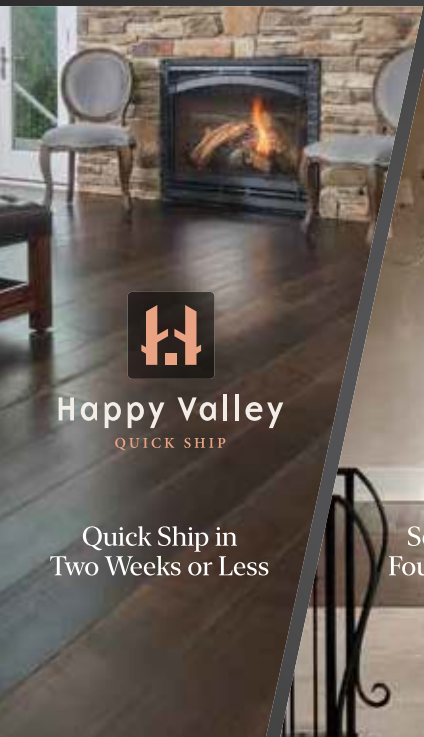

Happy Valley
QUICK SHIP

Quick Ship in
Two Weeks or Less



Big Valley
SEMI CUSTOM

Semi-Custom in
Four Weeks or Less



Blue Sky
FULLY CUSTOM

Fully-Custom
The Sky's the Limit!

Preview our new quick-ship and
custom wood flooring programs.

Booth 1111



PEACHEY
HARDWOOD FLOORING

The Beauty of Nature. Perfected.





Drive your company to greater growth and profitability in 2026.



Our Services

Wood Flooring Edge is our industry focused one-on-one coaching and consulting service. Members get expert advice and business coaching on a monthly basis.

Wood Flooring Exchange is our industry-specific business owner peer group program. Members share business challenges and learn the best practices from other business owners.

Expo
Special:
Get your
first month
of coaching
FREE!

"Growth Team Strategies helped us design a comprehensive and sustainable path forward. They are hands down the best investment we have made in our business to date."

-Mike Somodean, *Roswell Flooring*

Get started now! Scan the QR code to schedule a meeting with Doug.

www.growthteams.com



ESSEX

FINE WOOD FINISHING



Black Walnut and European Oak Flooring
Custom Finished and Private Labeled For You

We are way beyond a flooring company. Our untraditional approach is aimed at offering a wide range of privately labeled custom flooring. Our factory in New Jersey is specifically designed for complex finishes.

Contact us to curate your custom flooring selections!



CHAIR'S WELCOME



This year marks the 40th anniversary of the NWFA Wood Flooring Expo. When the first NWFA Convention (as it was known back then) took place in St. Louis, Missouri, in 1986, there were fewer than 200 attendees. Fast forward to today, where more than 2,000 wood flooring professionals can be found walking around the show floor.

We are proud to host the only trade show in the world dedicated exclusively to wood flooring. For four decades, the NWFA Expo has set the standard. As we mark this milestone, we raise it higher.

Throughout this week, you can experience more than 30 expert-led education sessions, live technical demonstrations, and more than 250 exhibitors showcasing new products and proven solutions.

Reconnect with old friends and meet some new ones at one of our many networking events. There is something for everyone with the New Member Reception, Distributor and Manufacturer Reception, Women's Industry Network Session, NWFA Emerging Leaders Reception, and the Grand Finale Celebration, to name a few.

This is where the industry advances. I hope the time you spend here in Orlando will equip you with everything you need to "Ignite Your Passion."

Steve Brattin
Chair, NWFA



Swiffer®

POWER MOP

WOOD



MOP SMARTER

**CLEANS FLOORS IN HALF
THE TIME VS. MOP & BUCKET***



Fine mist spray with
QUICKDRY formula.™

**DRIES UP TO
2X FASTER****



300+ gentle glide

ABSORB + LOCK™ STRIPS



Disposable Cloths

**MAKE CLEANUP
EASY**

*Vs. mop and bucket – includes cleaning and drying time.
**Vs. Mr. Clean® All Purpose Cleaner.

©2026 P&G

Sponsors

(as of 3.10.26)

Signature



Partner

- DuraSeal
- Hilltop Supply and Hardwood
- Mullican Flooring
- Sheoga Hardwood Flooring

Supporter

- Bostik, Inc.
- Chelsea Plank Flooring
- CORUS Fastening
- Elavon by U.S. Bank
- Lägler
- LATICRETE International Inc.
- LAUZON Hardwood Floors
- North American Association of Floor Covering Distributors
- Peachey Hardwood Flooring
- Pro-Drive Fasteners
- RW Supply & Design
- Wagner Meters

Friend

- Allegheny Mountain Hardwood Flooring
- Armenia Mountain Plank & Panel
- Coastal Surfaces
- Delmhorst Instrument Co.
- D&M Flooring
- Howell Hardwood Flooring
- Lambright Flooring
- Maxwell Hardwood Flooring Inc.
- Proflex Products Inc.
- Rubio Monocoat USA LLC
- SVB Wood Floors
- WW Flooring Group

Thank You
TO OUR SPONSORS
FOR YOUR SUPPORT



Loba[®]

On Top!

WAKOL[®]

Pursuing excellence unites



**LOBA WAKOL NORTH AMERICA
BOOTH #133**





DOWNLOAD THE NWFA EXPO APP FOR FREE

CUSTOMIZE YOUR EXPO EXPERIENCE



Search for “NWFA Expo” to download from iTunes or Google Play.

Have access to everything Expo related at your fingertips when you download the NWFA Expo mobile app. The app houses everything from the education and special events schedule to speaker bios and the exhibitor list. You can customize your schedule and bookmark the sessions and exhibitors you want to be sure not to miss.

Don't forget to allow push notifications so you receive show specials and updates throughout NWFA Expo. You can update your preferences in the settings of your phone's app manager.

FOLLOW THESE STEPS TO USE THE APP:

- Download the mobile app by searching for NWFA Expo 2026 in your iTunes or Google Play app store.
- Once the app downloads, open it on your mobile device.
- Enable push notifications and customize your schedule to make the most of your experience at Expo.

APP SPONSORED BY:

Bona[®]

SEE US AT BOOTH #901



SEE US AT BOOTH #1217

WI-FI INSTRUCTIONS

When you go into your wireless settings, search for the network “EXPO2026.” Select the network and enter the case-sensitive password:

NETWORK NAME: EXPO2026
PASSWORD: OldeWood (case sensitive)

WiFi sponsored by:  **OldeWood**
LIMITED

SEE US AT BOOTH #501



HORIZON
FOREST PRODUCTS

YOUR ONE STOP SHOP

Your One-Stop-Shop for: Unfinished Flooring, Prefinished Flooring, Waterproof Flooring.
INSTALLATION PRODUCTS: Adhesives, Moisture Protection, Underlayment, Protective
Overlays, Nailers, Large Machines, Small Machines. FINISHING PRODUCTS: Abrasives, Stains,
Water Based Finish, Oil Based Finish, Filler, Finishing Touches, Vents, Medallions, Moulding.

EVERYTHING YOU NEED

Your One-Stop-Shop for: Unfinished Flooring, Prefinished Flooring, Waterproof Flooring.
INSTALLATION PRODUCTS: Adhesives, Moisture Protection, Underlayment, Protective
Overlays, Nailers, Large Machines, Small Machines. FINISHING PRODUCTS: Abrasives, Stains,
Water Based Finish, Oil Based Finish, Filler, Finishing Touches, Vents, Medallions, Moulding.

Your One-Stop-Shop for: Unfinished Flooring, Prefinished Flooring, Waterproof Flooring.
INSTALLATION PRODUCTS: Adhesives, Moisture Protection, Underlayment, Protective
Overlays, Nailers, Large Machines, Small Machines. FINISHING PRODUCTS: Abrasives, Stains,
Water Based Finish, Oil Based Finish, Filler, Finishing Touches, Vents, Medallions, Moulding.

Your One-Stop-Shop for: Unfinished Flooring, Prefinished Flooring, Waterproof Flooring.
INSTALLATION PRODUCTS: Adhesives, Moisture Protection, Underlayment, Protective
Overlays, Nailers, Large Machines, Small Machines. FINISHING PRODUCTS: Abrasives, Stains,
Water Based Finish, Oil Based Finish, Filler, Finishing Touches, Vents, Medallions, Moulding.

1,000'S of SKUS | **22** LOCATIONS | **750,000+** SF of WAREHOUSES



VISIT US

CONTACT US TODAY!

Find your local branch: HorizonForest.com/contact



HORIZON
FOREST PRODUCTS

Schedule

(as of 3.10.26)

TUESDAY, APRIL 21

7:00 a.m. - 8:00 p.m. **Registration Open**

8:00 a.m. - 8:00 p.m. **Exhibitor Set-up**

8:00 a.m. - 3:00 p.m.

PRE-EXPO SYMPOSIUM

Data Collection: Building Defensible Inspection Reports

Jon Namba, Namba Services and Carl Mattingly, GalleherDuffy

Report Writing: Understanding Audience and Purpose

Cathy Duncan, EZ Report Writing

Legal Considerations: Ethics and Litigation Readiness

Barbara Dunn, Barbara Dunn Law and Billy Simmons, ITAC International

SPECIAL ADD-ON SESSIONS

8:30 a.m. - 3:30 p.m.

NWFA Certified Sales Advisor Session

Ashley Do Carmo, Brown Oaks Flooring, NWFA Certified Sales Advisor, and Regional Instructor; and Scott Taylor, NWFA Certified Wood Flooring Inspector and Regional Instructor

1:30 p.m. - 3:00 p.m.

Success and Succession

Doug Howard, Growth Team Strategies

3:30 p.m. - 4:15 p.m.

NEW MEMBER RECEPTION

Welcome to the NWFA! Join us to connect with fellow members, share insights, and learn how the association can support your business - all in a relaxed, welcoming setting.

4:30 p.m. - 5:45 p.m.

IGNITE YOUR PASSION OPENING SESSION

Join the NWFA at our opening session for an industry update, NWFA Wood Floor of the Year Awards, and more.

6:00 p.m. - 7:30 p.m.

SPARK RECEPTION

After the opening session, connect with fellow professionals and rekindle old friendships.

Expo Social Circle: Meet the Faces Behind the Posts | Meet your online connections at the Expo Social Circle, a relaxed gathering where social media conversations turn into real-world relationships. Connect with the people behind the posts to share insights, spark collaborations, and strengthen the wood flooring community - one conversation at a time.

When Using a Concrete
Meter, Use One That's

**2X MORE
ACCURATE**



For the 9 commonly used
concrete mix designs we
tested, the C555's readings
were significantly closer to
oven dry results.

Learn more:
wmmeters.com/3tK492Y



**WAGNER
METERS**



wmmeters.com/3tK492Y

Schedule

(as of 3.10.26)

WEDNESDAY, APRIL 22

7:30 a.m. - 9:30 a.m.

Morning Coffee

7:30 a.m. - 6:00 p.m.

Registration Open

SESSIONS

8:00 a.m. - 9:00 a.m.

Parquet Patterns: Building Custom Sleds

NWFA Regional Instructors

Using AI to Streamline Processes and Create Workplace Efficiency

Reid Lambright, Lambright Flooring; Andy Iamaio, Centricity; and Ryan McCord, Endeavor

To Fill or Not to Fill: The Science of Wood Floor Gapping

Mike Dittmer and Rob Johnson, Bona

When the Stain Isn't What They Expected: Avoiding Color Disasters

Toby Merrill, DuraSeal

9:15 a.m. - 10:15 a.m.

Layout and Installation of Custom Parquet Patterns

NWFA Regional Instructors

8 Leadership Skills for Wood Flooring Success:

Being the Leader Your Company Deserves

Doug Howard, Growth Team Strategies

Jobsite Troubleshooting: Solving Common Issues to Prevent Call Backs

Chad Bulen, Bostik and Tyler Powell, AllWell Agency

Design Intent and Jobsite Realities: Sharing Perspectives for Better Outcomes

Karen Asprea, Asprea Studio and Robyn Branch, Robyn Branch Design; Moderated by Lawrence Skutelsky, PID Floors

9:15 a.m. - 10:15 a.m.

WOMEN'S INDUSTRY NETWORK EVENT

Confidence in Action: Owning Your Superpower | Join us for WIFI's exclusive event, designed to empower and connect women in the floor covering industry. This interactive session will feature both a panel and tabletop discussion focused on pinpointing what your strong suit is and how to use those skills to stand out.

Brenda Cashion, UCX; Ashley Do Carmo, Brown Oaks Flooring; and Julie Russell, Gemini Industries; Moderated by Renee Tester, Kährs

10:30 a.m. - 5:00 p.m.

Trade Show Open | Exhibitor Demos | Concessions Open

4:00 p.m. - 5:00 p.m.

IT'S 5 O'CLOCK SOMEWHERE HAPPY HOUR

Grab a drink and network with peers on the trade show floor.

5:00 p.m. - 6:15 p.m.

DISTRIBUTOR & MANUFACTURER RECEPTION

Build new business relationships to expand your product reach.

5:30 p.m. - 6:45 p.m.

EMERGING LEADERS RECEPTION

Attendees aged 40 and younger are invited to attend.



Bruce®

WE'VE GOT UNFINISHED BUSINESS

Bruce®, the preferred partner in hardwood, now offers Bruce Unfinished™ hardwood—available in solid white and red oak, as well as a diverse range of unfinished engineered options. Made in the USA, Bruce hardwood floors have been trusted by trade professionals for over 150 years.

- Select Grade
- Square edges and ends for a seamless site finish
- Precision milled for a fast, easy installation

Bruce - the #1 most trusted name in hardwood



MADE IN THE USA
with U.S. and Global Components

See us at the
NWFA Expo
Booth #631

www.bruce.com 1-855-243-2521

*See warranty for additional details ©2026 AHF, LLC. All trademarks are owned by AHF, LLC, or its subsidiaries or affiliates.

Schedule



THURSDAY, APRIL 23

7:30 a.m. - 9:30 a.m.

Morning Coffee

7:30 a.m. - 3:00 p.m.

Registration Open

SESSIONS

8:00 a.m. - 9:00 a.m.

Sanding a Custom Parquet Pattern

NWFA Regional Instructors

Reduce HR Worries and Woes

Katie Magoon, People Solutions Center

Reading Commercial and Residential Specs

Billy Simmons, ITAC International

Social Media That Works on the Jobsite

Joe Avila, Huggins Wood Floors; Cesar Cardona, Cardona Flooring; Alex Hamilton, Grain Design Flooring; and Phil Valenti, Valenti Flooring; Moderated by Bridget Norlie, NWFA

9:15 a.m. - 10:15 a.m.

Staining and Finishing a Custom Parquet Floor

NWFA Regional Instructors

Freedom First: How Flooring Companies Scale Without Owner Dependency

Justin Shaw, Driven for Growth

Preserving the Past: An Introduction to Historic Wood Floor Restoration and Preservation

Sprigg Lynn, Universal Floors; Todd McDonald, Maple Ridge Handscraped; and Kevin Mullany, Benchmark Wood Floors

Channeling Your Inner Artist as a Craftsman

Jakko Woudenberg, the Dutch Wood Artist



THURSDAY, APRIL 23

EMERGING LEADERS PANELS

8:00 a.m. - 9:00 a.m.

Inside the Spec Panel: A Conversation Between A&D and the Wood Flooring Industry

Allison Watson Grim, Watson Design; Malcolm Jones, MAJ Architecture + Design; Amber C. Morales, A.Clore Interiors; and Lawrence Skutelsky, PID Floors; Moderated by Stephanie Owen, NWFA

9:15 a.m. - 10:15 a.m.

The Future Floor Panel & Q+A: Insights from the Next Generation of Industry Leaders

Izaiah Barrow, iSandNewYork LLC; Matt Bruno, Palermo Floor Inc.; and Alex Hamilton, Grain Design Flooring; Moderated by Kirk Roberts, Bona

10:30 a.m. - 3:00 p.m.

Trade Show Open | Exhibitor Demos | Concessions Open

3:00 p.m. - 4:30 p.m.

GRAND FINALE

Join us as we celebrate another successful NWFA Expo.

3:00 p.m. - 9:00 p.m.

Exhibitor Tear-Down

FRIDAY, APRIL 24

7:00 a.m. - 1:30 p.m.

NERF GOLF TOURNAMENT

Join us for the 2nd Annual NWFA Education & Research Foundation Golf Tournament, hosted at Disney's Palm Golf Course. This special event brings together industry professionals while supporting the NWFA's mission of attracting and training the next generation of flooring contractors and business owners.

8:00 a.m. - 12:00 p.m.

Exhibitor Tear-Down

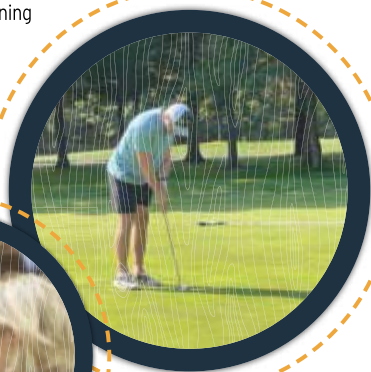



SURFACES

Design.
Innovation.
Collaboration.
All Angles
Covered.

Visit us at the NWFA Expo Booth #318

SAVE THE DATE tise 2027

Expo: February 2-4, 2027
Education: February 1-4, 2027
Mandalay Bay Convention Center
Las Vegas, NV



SCAN FOR THE
LATEST UPDATES!

Official SURFACES
Sponsors





Herringbone or Chevron?

Both herringbone and chevron flooring patterns add a nice touch of luxury and sophistication to interiors. Herringbone flooring planks are cut at 90 degree angles to create a distinct zig-zag pattern, while most chevron floors are cut to 45 degree angles. Other custom angles are available as well.



[View Online](#)

Classic. Timeless. Available in a wide variety of wood species.

Domestic

- ✓ Alder
- ✓ American Cherry
- ✓ American Cypress
- ✓ Aromatic Cedar
- ✓ Ash
- ✓ Australian Cypress
- ✓ Beech
- ✓ Birdseye Maple
- ✓ Curly Maple
- ✓ Domestic New Heart Pine
- ✓ Douglas Fir
- ✓ Euro Beech
- ✓ Hard Maple
- ✓ Hickory
- ✓ Locust
- ✓ Pecky Cypress
- ✓ Poplar
- ✓ Quartered Sawn Red Oak
- ✓ Quartered White Oak
- ✓ Red Birch
- ✓ Red Oak
- ✓ Rift & Quartered Red Oak
- ✓ Rift & Quartered White Oak
- ✓ Rift White Oak
- ✓ Walnut (Steamed)
- ✓ White Oak
- ✓ White Pine
- ✓ Wormy Chestnut
- ✓ Wormy Maple
- ✓ Wormy Red Oak
- ✓ Yellow Birch
- ✓ Yellow Pine

Exotic

- ✓ Brazilian Cherry
- ✓ Caribbean Heart Pine
- ✓ Cumaru (Brazilian Teak)
- ✓ IPE (Brazilian Walnut)
- ✓ Santos Mahogany
- ✓ Sapele
- ✓ Tigerwood

Exhibitors

LISTED BY NAME
(as of 3.10.26)

Companies in **TEAL** are advertisers in this guide and the April/May issue of *Hardwood Floors* magazine.
For descriptions of what they are displaying at the NWFA Wood Flooring Expo, see the Expo Exhibitor Showcase starting on page 46.

COMPANY NAME	BOOTH #	COMPANY NAME	BOOTH #
Advanced Adhesive Technologies, LLC.	609	CG Hardwood Molding	321
AFT - Advanced Flooring Technology	1327	Chelsea Plank Flooring	202
Aged Wide Floors	1222	Ciranova USA Inc.	408
AHF Products	631	Coastal Surfaces	1231
Akhurst Machinery Inc.	1030	Component Solutions	327
Alchemy Home Supply	443	CORUS Fastening	313
All American Wood Register Co.	917	Cross Country Hardwood LLC	444
Allegheny Mountain Hardwood Flooring	840	Cummings Lumber Company, Inc.	827
American Sanders	817	Cutco	426
Amorim Cork Solutions	731	D&M FLOORING	938
Anthony Vandyck Inc.	1331	Delmhorst Instrument Co.	834
Antique Building Solutions	1408	Denali Hardwood Floors	331
Appalachian Flooring Ltd.	1100	Divergent Adhesives	926
Appalachian Lumber Company	508	Dreweko / T&G Wood	311
Arboritec USA Inc	1308	Durapalm	1031
Arbortech Tools	1238	DuraSeal	701
Ark Floors	1329	Ecco Enterprises Ltd	219
Armenia Mountain Plank & Panel	835	Endeavor Al	422
Artistic Finishes Inc.	617	Essex Finishing	1041
Ashawa Bay Hardwood Floors	523	Finished Edge Technology LLC	931
Barlinek Floors	438	Floor Covering Industry Foundation	1417
Barreto Wood Finishings	239	Floorzap	229
Basic Coatings	808	Forteko LLC	326
Bauwerk Group US/Somerset Hardwood Flooring	301	Fortifiber Flooring Products	1335
Beasley Flooring Products	425	Galaxy Floor Sanding Machines Ltd.	511
Berger-Seidle	1117	GameTime Coatings	1239
Bjelin	1021	Gartman LLC	339
Bona	901	Glitsa - Lenmar, Gemini Industries	811
Bostik Inc.	1001	Graf Bros. Flooring	1133
BTP Floors	540	Graf Custom Hardwood	401
Buchanan Hardwood Flooring Co. LLC	1033	Graf Wood	1228
Buckeye Hardwoods	424	Great Lakes Custom Tool Mfg. Inc.	845
Cameron Automation	525	Grill Works Inc.	725
Canlak Coatings (PoloPlaz, Absco, & Sampson)	717	Growth Team Strategies	1319
Centricity	1413	Gundlach Tools	925
CFI - Certified Flooring Installers	841	Gutster Tools	206

Delmhorst[®]
INSTRUMENT CO

WHEN ACCURACY IS THE POINT.™

MOISTURE METERS

Moisture Meters for Lumber, Woodworking & Flooring

JX-20 & JX-30



- Fast and reliable readings
- Dashboard-like backlit display
- Export readings and generate reports via EDGE[®] app
- 2-year warranty



51 Indian Lane East
Towaco, NJ 07082



www.delmhorst.com



877-DELMHORST (335-6467)



info@delmhorst.com

Exhibitors

LISTED BY NAME
(as of 3.10.26)

COMPANY NAME	BOOTH #
Happy Feet International	409
Hardwood Solutions Inc.	334
Hasko/Mekanika	716
Hassell & Hughes Lumber Co., Inc.	733
Highland Automation	638
Hilltop Supply and Hardwood	125
Horizon Forest Products	201
Howell Hardwood Flooring	539
Indusparquet USA	441
Jackson Building Products	1123
JobTread	1317
Johnson Hardwood	738
Kährs Americas	433
L&L Hardwoods Inc.	932
Lamont Flooring	1126
Landen Strapping Corporation	839
Lastik USA	1341
LATICRETE International Inc.	1025
Lauzon Hardwood Floors	622
LED Coating Solutions by Archetypal	531
Lewis Brother's Lumber Company Inc.	309
Lico Machinery	919
Lignomat USA Ltd.	1125
Loba-Wakol North America	133
Macon Hardwood	522
MAPEI Corporation	1108
Mason Wood Floors	416
Maxwell Hardwood Flooring Inc.	517
Mercier Wood Flooring Inc.	700
Merrick Hardwoods	1008
Middle Tennessee Lumber	824
MIRAGE	1116
Mirka	208
Missouri Hardwood Products	317
Missouri Walnut LLC	204
MP Global Products LLC	1029
Mullican Flooring	1217

COMPANY NAME	BOOTH #
Next Floor Inc.	1323
No. Amer. Assn of Floor Covering Distributors	833
North Wood Flooring LLC	1213
Norton Abrasives	1201
NSP Panels	1124
NWFA/Hardwood Floors Magazine/NOFMA	801
Oakcrest Lumber Inc.	1005
Olde Wood Limited	501
Ort Flooring & Lumber LLC	325
Pacific Hardwood	312
PALLMANN	1301
Pantim Wood Products	524
Peachey Hardwood Flooring	1111
Penn Wood Products Inc.	423
Pennsylvania Lumbermen's Mutual Insurance Company	741
People Solutions Center	247
Permwood	233
PG Hardwood Flooring Inc.	611
Pianeta Legno Floors USA Inc.	607
Pownail Company	1017
Precision Flooring Products Inc.	319
Premiere Finishing & Coating	613
Prestige Enterprise International Inc.	1410
Preverco	933
Primatex Inc.	1034
Pro-Drive Fasteners	1130
Professional Coatings Inc.	1009
Proflex Products Inc.	1312
QT Sound Control (Ecore)	720
Regupol Acoustics	626
Reliance Hardwood Flooring	207
Ribadao Wood Boutique	1401
Ridgefield Wood Vents/Unity Hardwoods	1211
Roomvo	421
RT Machine Company	844
Rubberlogix	200
Rubio Monocoat USA LLC	625

STO SERIES

HIGH-CAPACITY OPTIMIZED CROSS-CUT SAW SYSTEM



**STANDS OUT
FOR ITS SPEED,
ACCURACY AND
STURDY DESIGN**

**DEVELOPED
ESPECIALLY
FOR FLOORING**

**SYSTEM
INTEGRATED
IN OUR ADAPTED
SOLUTIONS**

For more than 20 years, Lico Machinery Inc. has stood out for the quality of its equipment, its adapted solutions, as well as its unique and unbeatable service. Lico specializes in the design and manufacture of sawmill and flooring equipment ranging from standalone machines to complete solutions. No compromise is made on the quality of the equipment, from design to installation, because we know that in a world where profitability depends on productivity, only quality performs.



9550 10th Avenue Industrial Park
Saint-Georges (Quebec) G5Y 8J8

418 228-3882
licoinc.net

Exhibitors

LISTED BY NAME
(as of 3.10.26)

COMPANY NAME	BOOTH #	COMPANY NAME	BOOTH #
Sanderparts.com	240	Toray Plastics (America)	605
Saroyan	1306	Tradelink Wood Products Inc.	520
Schafer Hardwood Flooring	213	Tramex Moisture Meters	825
Seneca Millwork	1012	TRAXX Corporation	323
SGS North America	218	Triangulo Hardwood Floors	1038
Shaper	216	Trivec	419
Sheoga Hardwood Flooring	708	Union Tool Corporation, The	417
Sika Corporation	516	Unity Hardwoods	1211
SLCC Enterprise Inc.	1321	Urban Floor	322
SmartPlank	830	US Sander LLC	1409
Soest Wood Finishing Machinery	727	Vecoplan	1139
Solidfloor by LTL Home Products	930	Vermeister America Inc.	1129
Southern Winding Service Inc.	338	Vermont Natural Coatings	621
Springcreek Flooring	601	Virginia Abrasives Corp.	709
Stauf USA LLC	924	V-Pro	1127
Stellar Air Vents	1234	Wagner Meters	1016
Super Thin Saws Inc.	1032	WarmStep Electric Floor Heating	639
Superior Hardwood Flooring	939	Waterlox Coatings Corporation	831
Swiffer	332	WECORK	909
Taylor Adhesives	1416	Wickham Hardwood Flooring	706
TEKA Hardwood Flooring by PlyQuet of America Inc.	1207	WOCA Denmark	1309
Terra Legno	1122	Wood Products Manufacturers Association	541
Three Trees Flooring	1223	WoodTech Machines	1104
tise - The International Surface Event	318	WOODWISE	1101
Titebond	911	World Floor Covering Association	1425
Top Step Vents	1020	WW Flooring Group	619

Ignite
YOUR PASSION



ALPINE™

- Unlimited moisture protection
- No moisture or PH testing required
- Aggressive tack, fast-grab formula
- Permanent, waterproof bond



SCAN TO
LEARN MORE



TAYLOR
ADHESIVES

An Avery Dennison Company

nwfa expo

SAVE THE DATE

FOR NETWORKING, DEMOS, EDUCATION, TRADE SHOW & MORE!

Mark your calendar now to attend next year's Wood Flooring Expo to see all the latest products and services our industry has to offer.



FORT WORTH
2027

WWW.NWFAEXPO.ORG
800.422.4556

nwfa
National Wood
Flooring Association



BAUWERK GROUP

NORTH AMERICA

Booth
301



Prestige, Oak White

One Global Group. Two Trusted Brands.
Hand crafted in North America and Europe.
Supported locally throughout the U.S.



BOEN

boen.com



somersefloors.com

MADE IN USA



ABRASIVES

Arboritec USA Inc.	1308
Berger-Seidle	1117
Bona	901
Hilltop Supply and Hardwood	125
Loba-Wakol	133
Mirka	208
Norton Abrasives	1201
Traxx Corporation	323
US Sander LLC	1409
Virginia Abrasives Corp.	709

ADHESIVES

Advanced Adhesive Technologies LLC	609
Arboritec USA Inc.	1308
Berger-Seidle	1117
Bona	901
Bostik Inc.	1001
Divergent Adhesives	926
Hilltop Supply and Hardwood	125
Lastik USA	1341
Loba-Wakol	133
MAPEI Corporation	1108
PALLMANN	1301
Proflex Products Inc.	1312
Sika Corporation	516
Stauf USA LLC	924
Taylor Adhesives	1416
Titebond	911
Vermeister America Inc.	1129
WECORK	909

APPLICATORS

Arboritec USA Inc.	1308
Berger-Seidle	1117
Glitsa - Lenmar, Gemini Industries	811
Lastik USA	1341
Norton Abrasives	1201
Stauf USA LLC	924
Trivec	419
Union Tool Corporation, The	417
US Sander LLC	1409

BAMBOO

Penn Wood Products Inc.	423
-------------------------	-----

BLADES AND BITS

CORUS Fastening	313
Gundlach Tools	925
RT Machine Company	844
Super Thin Saws Inc.	1032

BORDERS/INLAYS/MEDALLIONS

Penn Wood Products Inc.	423
Saroyan	1306
Seneca Millwork	1012
Shaper	216
Top Step Vents	1020

BUSINESS SERVICES

Centricity	1413
Gartman LLC	339
Growth Team Strategies	1319
No. Amer. Association of Floor Covering Distributors	833
Pennsylvania Lumbermens Mutual Insurance Company	741
Premiere Finishing & Coating	613
Roomvo	421
RT Machine Company	844
Wood Products Manufacturers Association	541

CORK

WECORK	909
--------	-----

DOMESTIC WOOD FLOORING

AHF Products	631
Allegheny Mountain Hardwood Flooring	840
Anthony Vandyck Inc.	1331
Appalachian Flooring Ltd.	1100
Appalachian Lumber Company	508
Armenia Mountain Plank & Panel	835
Ashawa Bay Hardwood Floors	523
Barlinek Floors	438
Bauwerk Group US/Somerset Hardwood Flooring	301
Beasley Flooring Products	425
Buchanan Hardwood Flooring Co. LLC	1033
Chelsea Plank Flooring	202
Graf Bros. Flooring	1133
Graf Custom Hardwood	401
Hardwood Solutions Inc.	334
Hassell & Hughes Lumber Co. Inc.	733
Hilltop Supply and Hardwood	125
Howell Hardwood Flooring	539



ARMENIA
MOUNTAIN
plank & panel



**BEYOND
STANDARD GRADES**
see what custom really looks like

Stop by Booth 835 for a Tour

Manufactured at our facility in Troy, PA

570.995.1892

www.armeniaplank.com



DOMESTIC WOOD FLOORING, CONT.

Johnson Hardwood	738
Lauzon Hardwood Floors	622
Macon Hardwood	522
Maxwell Hardwood Flooring Inc.	517
Merrick Hardwoods	1008
Mirage	1116
Missouri Hardwood Products	317
Missouri Walnut LLC	204
Mullican Flooring	1217
Ort Flooring & Lumber LLC	325
Peachey Hardwood Flooring	1111
PG Hardwood Flooring Inc.	611
Pianeta Legno Floors USA Inc.	607
Prestige Enterprise International Inc.	1410
Preverco	933
Reliance Hardwood Flooring	207
Saroyan	1306
Seneca Millwork	1012
Sheoga Hardwood Flooring	708
Springcreek Flooring	601
Unity Hardwoods	1211
Wickham Hardwood Flooring	706
WW Flooring Group	619

ELECTRONICS/TECHNOLOGY

Gartman LLC	339
Landen Strapping Corporation	839
Lignomat USA Ltd.	1125
RT Machine Company	844
SmartPlank	830
WarmStep Electric Floor Heating	639

END GRAIN WOOD FLOORING

Allegheny Mountain Hardwood Flooring	840
Saroyan	1306
Seneca Millwork	1012
Triangulo Hardwood Floors	1038

ENGINEERED WOOD FLOORING

Aged Wide Floors	1222
AHF Products	631
Allegheny Mountain Hardwood Flooring	840
Anthony Vandyck Inc.	1331
Appalachian Flooring Ltd.	1100
Appalachian Lumber Company	508
Arboritec USA Inc.	1308
Armenia Mountain Plank & Panel	835
Ashawa Bay Hardwood Floors	523
Barlinek Floors	438
Bauwerk Group US/Somerset Hardwood Flooring	301
Beasley Flooring Products	425
D&M Flooring	938
Dreweko/T&G Wood	311
Durapalm	1031
Essex Finishing	1041
Graf Bros. Flooring	1133
Graf Custom Hardwood	401
Hilltop Supply and Hardwood	125
Howell Hardwood Flooring	539
Indusparquet USA	441
Johnson Hardwood	738
Lamont Flooring	1126
Lauzon Hardwood Floors	622
Macon Hardwood	522
Mason Wood Floors	416
Maxwell Hardwood Flooring, Inc.	517
Mirage	1116
Mullican Flooring	1217
Olde Wood Limited	501
Ort Flooring & Lumber LLC	325
Peachey Hardwood Flooring	1111
Permwood	233
PG Hardwood Flooring Inc.	611
Pianeta Legno Floors USA Inc.	607
Preverco	933
Reliance Hardwood Flooring	207
Saroyan	1306
Sheoga Hardwood Flooring	708
Solidfloor by LTL Home Products	930
Three Trees Flooring	1223
Triangulo Hardwood Floors	1038
Wickham Hardwood Flooring	706



*Now Offering Prefinished & Unfinished
Premium Hardwood Floors*

True. Dependable. Reliable.

Clarion, PA



Dickson, TN

RELIANCE

hardwood flooring

615-560-0324 office

www.reliancehardwoodflooring.com

nwfa expo

2026

ORLANDO

APRIL 21-23 | NWFAEXPO.ORG

stop by
Booth 207

FACTORY-FINISHED WOOD FLOORING

Anthony Vandyck Inc.	1331
Appalachian Flooring Ltd.	1100
Arboritec USA Inc	1308
Barlinek Floors	438
Bauwerk Group US/Somerset Hardwood Flooring	301
Bjelin	1021
Chelsea Plank Flooring	202
Dreweko/T&G Wood	311
Durapalm	1031
Essex Finishing	1041
Graf Custom Hardwood	401
Indusparquet USA	441
Johnson Hardwood	738
Lamont Flooring	1126
Lauzon Hardwood Floors	622
Macon Hardwood	522
Mason Wood Floors	416
Mirage	1116
Missouri Hardwood Products	317
Mullican Flooring	1217
Ort Flooring & Lumber LLC	325
Peachey Hardwood Flooring	1111
Permwod	233
PG Hardwood Flooring Inc.	611
Pianeta Legno Floors USA Inc.	607
Premiere Finishing & Coating	613
Prestige Enterprise International Inc.	1410
Preverco	933
Reliance Hardwood Flooring	207
Saroyan	1306
Seneca Millwork	1012
Solidfloor by LTL Home Products	930
Three Trees Flooring	1223
Triangulo Hardwood Floors	1038
Wickham Hardwood Flooring	706
WW Flooring Group	619

FILLERS

Arboritec USA Inc	1308
Berger-Seidle	1117
Bona	901
DuraSeal	701
Glitsa - Lenmar, Gemini Industries	811
Hilltop Supply and Hardwood	125
MAPEI Corporation	1108
Vermeister America Inc.	1129
WOODWISE	1101

FINISHES/COLORANTS

American Sanders	817
Arboritec USA Inc	1308
Artistic Finishes Inc.	617
Basic Coatings	808
Berger-Seidle	1117
Bona	901
Canlak Coatings (PoloPlaz, Absco, & Sampson)	717
Ciranova USA Inc.	408
DuraSeal	701
Glitsa - Lenmar, Gemini Industries	811
Hilltop Supply and Hardwood	125
Horizon Forest Products	201
LED Coating Solutions by Archetypal	531
Loba-Wakol	133
MAPEI Corporation	1108
PALLMANN	1301
Penn Wood Products Inc.	423
Pianeta Legno Floors USA Inc.	607
Professional Coatings Inc.	1009
Rubio Monocoat USA LLC	625
Soest Wood Finishing Machinery	727
US Sander LLC	1409
Vermeister America Inc.	1129
Vermont Natural Coatings	621
Waterlox Coatings Corporation	831
WOCA Denmark	1309

FLOATING WOOD FLOORING

AHF Products	631
Barlinek Floors	438
Dreweko/T&G Wood	311
Durapalm	1031
Indusparquet USA	441
Johnson Hardwood	738
Mirage	1116
Solidfloor by LTL Home Products	930
Triangulo Hardwood Floors	1038
WW Flooring Group	619

FLOOR MANUFACTURING EQUIPMENT AND SUPPLIES

Akhurst Machinery Inc.	1030
Buchanan Hardwood Flooring Co. LLC	1033
Delmhorst Instrument Co.	834
Great Lakes Custom Tool Mfg. Inc.	845
Hasko/Mekanika	716
Landen Strapping Corporation	839

Make Glitsa IDRO CLEAR™ Your GO-TO Finish

Glitsa IdroClear™ is a premium, single-component waterborne finish designed for professional results. With exceptional flow, leveling, and open time, IdroClear™ delivers a crystal-clear, even finish – even on challenging layouts. With the easy addition of the Glitsa Waterborne Hardener, Glitsa IdroClear™ becomes a powerful 2K Finish with superior durability.

- Silky Touch
- Superior Flow & Leveling
- Beautiful Clear Finish

**VISIT GLITSA.COM
TO FIND OUT MORE**



IDRO CLEAR 1K

- Self-Sealing Finish
- Easy Application



IDRO CLEAR w/ Hardener

- Full 2K durability
- Same Easy Application

**COME VISIT US AT BOOTH #811
AT NWFA EXPO IN ORLANDO**



LENMAR®

Waterborne • Conversion Varnish • Polyurethane

FLOOR MANUFACTURING EQUIPMENT AND SUPPLIES, CONT.

LED Coating Solutions by Archetypal	531
Lico Machinery	919
NSP Panels	1124
RT Machine Company	844
Union Tool Corporation, The	417
V-Pro	1127
WoodTech Machines	1104

GYM FLOORS

Basic Coatings	808
Bauwerk Group US/Somerset Hardwood Flooring	301
Lauzon Hardwood Floors	622
Loba-Wakol	133
Macon Hardwood	522
Ort Flooring & Lumber LLC	325
Prestige Enterprise International, Inc.	1410
Vermont Natural Coatings	621
WECORK	909
WW Flooring Group	619

IMPORTED WOOD FLOORING SPECIES

AHF Products	631
Anthony Vandyck Inc.	1331
Bauwerk Group US/Somerset Hardwood Flooring	301
Dreweko/T&G Wood	311
Durapalm	1031
Indusparquet USA	441
Johnson Hardwood	738
Lauzon Hardwood Floors	622
Macon Hardwood	522
Mason Wood Floors	416
Maxwell Hardwood Flooring Inc.	517
Mullican Flooring	1217
Pianeta Legno Floors USA Inc.	607
Saroyan	1306
Seneca Millwork	1012
Three Trees Flooring	1223
Triangulo Hardwood Floors	1038
WW Flooring Group	619

INDUSTRY ORGANIZATIONS

CFI - Certified Flooring Installers	841
No. Amer. Assn of Floor Covering Distributors	833
NWFA - Expo Live - <i>Hardwood Floors Magazine</i>	801
tise - The International Surface Event	318
Wood Products Manufacturers Association	541

MAINTENANCE PRODUCTS

American Sanders	817
Arboritec USA Inc.	1308
Basic Coatings	808
Bona	901
Canlak Coatings (PoloPlaz, Absco, & Sampson)	717
Ciranova USA Inc.	408
DuraSeal	701
Glitsa - Lenmar, Gemini Industries	811
Lignomat USA Ltd.	1125
Loba-Wakol	133
MAPEI Corporation	1108
Norton Abrasives	1201
PALLMANN	1301
Pro-Drive Fasteners	1130
Professional Coatings Inc.	1009
RT Machine Company	844
Rubio Monocoat USA LLC	625
Southern Winding Service Inc.	338
Swiffer	332
Taylor Adhesives	1416
Vermeister America Inc.	1129
Vermont Natural Coatings	621
Virginia Abrasives Corp	709
WOCA Denmark	1309
WOODWISE	1101

MISCELLANEOUS TOOLS/ SUPPLIES/MOISTURE METERS

CORUS Fastening	313
Delmhorst Instrument Co.	834
Great Lakes Custom Tool Mfg. Inc.	845
Gundlach Tools	925
Lastik USA	1341
Lignomat	1125
Mirka	208
Powernail Company	1017
Pro-Drive Fasteners	1130
Shaper	216
Super Thin Saws Inc.	1032
Tramex Moisture Meters	825
Traxx Corporation	323
Virginia Abrasives Corp	709
Wagner Meters	1016
WoodTech Machines	1104

Lignomat

Moisture Meters



Proven measuring technology.
Accurate. Every time. Every day.

Measure and monitor:

- Hardwood floors
- Engineered floors
- Subfloors
- Concrete pin, pinless, in-situ RH
- Relative Humidity / Temperature



Pin-Pinless-RH-Insitu

Come and visit our booth. **1125**

See for yourself the quality and ease of usage of Lignomat meters.

We have fair and competitive prices.

Take advantage of the NWFA Show discount and save !!!!



If you could not make it to the booth, Specials are good to **May 15, 2026** with QR code.

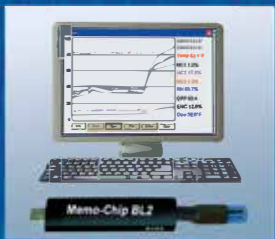

Call 800-227-2105
www.Lignomat.com

MOULDINGS/STAIR PARTS/TRIM

AHF Products	631
All American Wood Register Co.	917
Anthony Vandyck Inc.	1331
Antique Building Solutions	1408
Appalachian Lumber Company	508
Artistic Finishes Inc.	617
Bauwerk Group US/Somerset Hardwood Flooring	301
CG Hardwood Molding	321
Chelsea Plank Flooring	202
Essex Finishing	1041
Grill Works Inc.	725
Hilltop Supply and Hardwood	125
L&L Hardwoods Inc.	932
Lamont Flooring	1126
Macon Hardwood	522
Mercier Wood Flooring Inc.	700
Middle Tennessee Lumber	824
Mirage	1116
NSP Panels	1124
Peachey Hardwood Flooring	1111
Penn Wood Products Inc.	423
Ridgefield Wood Vents/Unity Hardwoods	1211
Saroyan	1306
Seneca Millwork	1012
SLCC Enterprise, Inc.	1321
Traxx Corporation	323
Unity Hardwoods	1211
WECORK	909

NAILERS/FASTENERS

Arboritec USA Inc.	1308
CORUS Fastening	313
Hilltop Supply and Hardwood	125
Pownail Company	1017
Primatch Inc.	1034
Pro-Drive Fasteners	1130
Traxx Corporation	323
WOODWISE	1101

PARQUET/HERRINGBONE/ CHEVRON WOOD FLOORING

Allegheny Mountain Hardwood Flooring	840
Anthony Vandyck Inc.	1331
Appalachian Lumber Company	508
Armenia Mountain Plank & Panel	835
Ashawa Bay Hardwood Floors	523
Barlinek Floors	438
Bauwerk Group US/Somerset Hardwood Flooring	301
Dreweko/T&G Wood	311
Essex Finishing	1041
Graf Bros. Flooring	1133
Graf Custom Hardwood	401
Lamont Flooring	1126
Lauzon Hardwood Floors	622
Macon Hardwood	522
Maxwell Hardwood Flooring Inc.	517
Mirage	1116
Mullican Flooring	1217
Peachey Hardwood Flooring	1111
Pianeta Legno Floors USA Inc.	607
Premiere Finishing & Coating	613
Preverco	933
Reliance Hardwood Flooring	207
Saroyan	1306
Seneca Millwork	1012
Sheoga Hardwood Flooring	708
Solidfloor by LTL Home Products	930
Three Trees Flooring	1223
Unity Hardwoods	1211

RECLAIMED WOOD FLOORING

Antique Building Solutions	1408
Armenia Mountain Plank & Panel	835
Dreweko/T&G Wood	311
Durapalm	1031
Hilltop Supply and Hardwood	125
Macon Hardwood	522
Olde Wood Limited	501
Peachey Hardwood Flooring	1111
Pianeta Legno Floors USA Inc.	607
Premiere Finishing & Coating	613
Reliance Hardwood Flooring	207
Saroyan	1306

RESTORATION EQUIPMENT

Mirka	208
Shaper	216
V-Pro	1127

RECLAIMED
and
BESPOKE BUILDING MATERIALS

ANTIQUE

BUILDING SOLUTIONS

ESTD. *Howard, Pennsylvania* 1998

FLOATING
TREADS
THAT TURN
HEADS.

WWW.ANTIQUEBUILDINGSOLUTIONS.COM

nwfa
National Wood
Flooring Association

SANDING EQUIPMENT

Akhurst Machinery Inc.	1030
American Sanders	817
Arboritec USA Inc.	1308
Basic Coatings	808
Bona	901
Hilltop Supply and Hardwood	125
Mirka	208
PALLMANN	1301
Southern Winding Service Inc.	338
Trivec	419
US Sander LLC	1409
Virginia Abrasives Corp.	709
WoodTech Machines	1104
WOODWISE	1101

SOFTWARE, INSTALLATION MGT.

Gartman LLC	339
JobTread	1317

SPECIALTY WOOD FLOORING

Allegheny Mountain Hardwood Flooring	840
Barlinek Floors	438
Bauwerk Group US/Somerset Hardwood Flooring	301
Dreweko/T&G Wood	311
Durapalm	1031
Essex Finishing	1041
Graf Custom Hardwood	401
Hilltop Supply and Hardwood	125
Indusparquet USA	441
Macon Hardwood	522
Mason Wood Floors	416
Maxwell Hardwood Flooring Inc.	517
Olde Wood Limited	501
Peachey Hardwood Flooring	1111
Pianeta Legno Floors USA Inc.	607
Premiere Finishing & Coating	613
Prestige Enterprise International, Inc.	1410
Reliance Hardwood Flooring	207
Saroyan	1306
Seneca Millwork	1012
Shaper	216
Solidfloor by LTL Home Products	930
Triangulo Hardwood Floors	1038

SUBFLOORS

Bostik Inc.	1001
Lignomat USA Ltd.	1125
Loba-Wakol	133
MP Global Products LLC	1029
Ort Flooring & Lumber LLC	325

SUBFLOORS, CONT.

PALLMANN	1301
Prestige Enterprise International Inc.	1410
Proflex Products Inc.	1312
Regupol Acoustics	626
Sika Corporation	516
Stauf USA LLC	924
Taylor Adhesives	1416
Vermeister America Inc.	1129
Wagner Meters	1016

UNDERLAYMENTS

Barlinek Floors	438
Bostik Inc.	1001
Fortifiber Flooring Products	1335
Hilltop Supply and Hardwood	125
Jackson Building Products	1123
Laticrete International, Inc.	1025
Loba-Wakol	133
MAPEI Corporation	1108
MP Global Products LLC	1029
Prestige Enterprise International, Inc.	1410
Proflex Products Inc.	1312
QT Sound Control (Ecore)	720
Regupol Acoustics	626
Sika Corporation	516
SLCC Enterprise, Inc.	1321
Toray Plastics (America)	605
Traxx Corporation	323
WarmStep Electric Floor Heating	639
WECORK	909

VENTS

All American Wood Register Co.	917
Artistic Finishes Inc.	617
CG Hardwood Molding	321
Essex Finishing	1041
Grill Works Inc.	725
Hilltop Supply and Hardwood	125
Macon Hardwood	522
Mercier Wood Flooring Inc.	700
Peachey Hardwood Flooring	1111
Penn Wood Products Inc.	423
Ridgefield Wood Vents/Unity Hardwoods	1211
Seneca Millwork	1012
Shaper	216
Sheoga Hardwood Flooring	708
Stellar Air Vents	1234
Top Step Vents	1020
Triangulo Hardwood Floors	1038



Top Step Vents

DECORATIVE FLUSH MOUNT
METAL VENTS



ALSO AVAILABLE:



DIY VENT SOLUTIONS



CUSTOM SIZES

WHAT CAN NWFA DO FOR YOU?



REAL MEMBERS. REAL RESULTS.

"THE NWFA has been such a valuable resource for me and my career. THE HANDS-ON TRAINING helped solidify all the things that I actually was doing right. The NWFA COMPLETELY CHANGED THE ENTIRE TRAJECTORY OF MY LIFE."

— ALEX HAMILTON, Grain Design Flooring
2025 NWFA Wood Floor of the Year Members' Choice Winner

Being a wood flooring professional has never been more complicated than it is today. There is a lot of uncertainty out there impacting your business. One thing that remains certain is NWFA's commitment to you and your company. The NWFA is expanding and implementing products and services that can help your business thrive.



▲ SCAN TO JOIN

Join NWFA Today!



NATIONAL WOOD FLOORING ASSOCIATION
NWFA.ORG | 800.422.4556

For more details, visit
[NWFA.ORG/MEMBERSHIP/](https://www.nwfa.org/membership/)



THE FUTURE OF WOOD SURFACE FINISHING IS HERE

High-Performance, Cutting-Edge LED Curing
Technology for the Wood Finishing Industry



See for yourself at **Booth #531**

LED
COATING SOLUTIONS

by



Learn more at ledcoatingsolutions.com | Contact: office@ledcoatingsolutions.com

  @ledcoatingsolutions

Exhibitor SHOWCASE



ALLEGHENY MOUNTAIN HARDWOOD FLOORING

Booth 840

Rift and quartersawn Allegheny Mountain Hardwood Flooring Red Oak delivers straight, striking grain with smaller medullary rays, exceptional stability, and versatility from rustic to modern. Sourced from tight-growth northern Appalachian forests, it costs less than white oak yet stains beautifully and performs over radiant heat – letting contractors boost margins while offering clients premium performance and aesthetic.

hickmanwoods.com



ANTIQUÉ BUILDING SOLUTIONS

Booth 1408

Deeply rooted in American heritage, our reclaimed white oak floating treads are salvaged from 19th-century barns to bring history home. Available in 2" to 4" thicknesses – as solid timber or dual-piece glue-ups – each tread showcases centuries of slow-growth grain and storied patina. Can come nude or prefinished.

antiquebuildingsolutions.com



APPALACHIAN LUMBER COMPANY

Booth 508

Producing engineered and solid plank flooring, mouldings, stair parts, treads, risers, box newels, handrails, and more. Specializing in the unique and hard-to-find. Stocking more than 20 species, with inventory of many stock items. Give us an opportunity on your next special hardwood job.

appalachianlumber.net



ARMENIA MOUNTAIN PLANK & PANEL

Booth 835

Custom wide plank engineered and solid flooring – precision milled “One Plank at a Time” at our facility in Troy, Pennsylvania. Our customer-focused approach, perfect-fit milling, and glued plywood T&G joint for superior stability make us a trusted partner you can rely on. We offer capabilities to suit a variety of design needs, including: widths up to 12”, herringbone and chevron patterns, and three-layer balanced construction.

armeniaplank.com



IGNITE YOUR PASSION

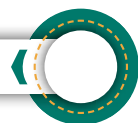

Our Rift & Quartered Red Oak is crafted from premium Northern Appalachian hardwoods, precision milled with consistent grading and long lengths. It delivers the clean, linear look your customers want — with the warm undertones making a strong comeback.

Offer a beautiful alternative to costly white oak. Save your clients money, improve your margins, and give your crews an easier install with flooring built for performance.

@hickmanwoods



RIFT & QUARTER SAWN

RED OAK

*BY ALLEGHENY MOUNTAIN
HARDWOOD FLOORING*

501 Main St. Emlenton, PA 16373

www.hickmanwoods.com | 724.867.9441

@hickmanwoods | 100% FSC Certified PA Hardwoods



Exhibitor SHOWCASE



BERGER-SEIDLE

Booth 1117

AquaSeal® GreenStar by Berger-Seidle® is a premium, two-component, waterborne polyurethane finish that delivers outstanding durability and workability. Free of isocyanates, aziridine, and hazard labeling, AquaSeal® GreenStar represents a new generation of environmental, user, and health protection. With its 18-hour pot life and high chemical resistance, AquaSeal® GreenStar sets new standards in high-performance wood floor finishing.

berger-seidle.com

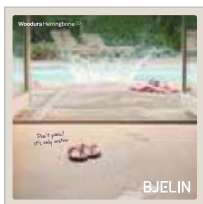

BJELIN

Booth 1021

Bjelin's Woodura Herringbone 3.0 combines high-quality FSC®-certified Croatian oak with smart, innovative engineering to create a more durable, eco-friendly floor. Herringbone is a timeless choice that adds character and elegance to any space – a stylish flooring option you can feel good about.

bjelin.com



BONA

Booth 901

Bona is the foundation of beautiful hardwood floors around the world. The Bona System works in synergy to deliver consistent, high-quality results every time. We didn't just create the first complete system for hardwood flooring professionals, we defined it. Visit Bona at Booth #901 to learn how our system can elevate your projects.

bona.com



BRUCE®, A BRAND OF AHF PRODUCTS

Booth 631

Bruce® Natural Choice™ is real solid hardwood that installs easily with SUMMIT™ SELECT, a pioneering glue-down adhesive. Offered in 2¼" and 3¼" widths, it provides flexible design options. Made in the U.S.A., this 5/16" low-profile flooring delivers timeless wood beauty, durable performance, and modern installation advantages.

bruce.com

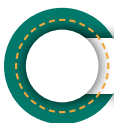

IGNITE YOUR PASSION



Woodura Herringbone ^{3.0}

HERRINGBONE FLOOR MADE FOR *real life*

Don't panic!
It's only water.

72h

WATER
PROOF



Discover more at →

us.bjelin.com

BJELIN

Exhibitor SHOWCASE



CANLAK COATINGS

Booth 717

Absco RED X Pro Red Blocker is a one-step waterborne formula designed to block the red and pink tones of certain wood species, especially red oak, to help mimic the look of white oak flooring. RED X Pro is not a bleach, but a low-odor, quick-drying water-based formula that can be used as a blocker to help achieve lighter wood tones and is compatible with all Absco products. RED X Pro works with many red-toned wood species such as red oak or cherry.

canlakcoatings.com



CORUS FASTENING

Booth 313

Lightweight. Powerful. Reliable. The CORUS BCSS0-R 15-1/2 Flooring Stapler features tool-free depth adjustment, non-marring urethane roller system, fast magazine loading, and ergonomic comfort at just nine pounds.

corusfastening.com



DELMHORST

Booth 834

The JX-20 and JX-30 meters offer a professional-grade, accurate, and versatile tool to flooring professionals and inspectors to address moisture issues and perform your job with complete confidence. The JX-30 features connectivity to the Delmhorst EDGE® app with expanded wood species, customizable settings, and the ability to share data from any location.

delmhorst.com



DENALI HARDWOOD FLOORS

Booth 331

The Mason Collection offers three thoughtfully curated colors, including Arcade, each expressing the rustic beauty of European Oak. Nature+ grading reveals authentic knots and tonal variation for a warm, lived-in feel. With 8 $\frac{1}{2}$ " wide planks, $\frac{5}{8}$ " thickness, and a 4mm sawn veneer, it delivers lasting stability for residential and light commercial spaces.

denalihardwoodfloors.com



IGNITE YOUR PASSION

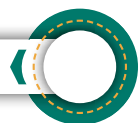

FOR A CLEAN, NATURAL LOOK, GRAND CLEAR 1K DELIVERS.

Today's customers want floors that stay true to the wood. Clear. Natural. Modern.

Absco Grand Clear 1K is a Non-Yellowing, single-component finish that keeps floors looking clear over time while delivering long-lasting protection.

Easy to apply. Easy to manage. Built for contractors who want fewer headaches and fewer callbacks.

- Non-Yellowing finish that stays clear over time
- Single-component simplicity with professional-grade durability
- Easy application that helps reduce costly callbacks



FINISH
WITH CONFIDENCE.



Exhibitor SHOWCASE



DURAPALM BY SMITH & FONG

Booth 1031

Durapalm flooring is crafted from plantation-grown palm wood, offering bold linear grain, rich natural variation, and a distinctly tropical character. Dense and durable, it provides a renewable alternative to traditional hardwoods for residential, hospitality, and commercial interiors seeking warmth, texture, and something truly unique.

durapalm.com



ESSEX FINISHING

Booth 1041

Essex's untraditional approach is aimed at offering a wide range of custom hardwood flooring. Our factory in New Jersey is specially designed for complex niches and small runs. Featured here is faded grey, an in-house smoked, wire-brushed, and hand-stained European Oak available in both prime and character grades.

essexandco.com



GAMETIME COATINGS

Booth 1239

GameTime Phoenix is a premium two-component water-based coating with an eight-hour pot life. Phoenix was engineered for consistent results and ease of application. Available in four sheens, Phoenix has what you need for even your most particular customer. Reach out today to get in the Game.

gametimecoatings.com



GLITSA - LENMAR, GEMINI INDUSTRIES

Booth 811

No crosslinker required – Idro Clear™ uses oxidative curing to achieve a durable, chemically resistant film. This single-component waterborne finish provides excellent flow, uniform leveling, and rapid recoat times. Available in satin or matte, Idro Clear delivers consistent film build, strong scratch resistance, and efficient application for professional wood flooring workflows.

glitsa.com



GROWTH TEAM STRATEGIES

Booth 1319

We are a business consulting and coaching company focusing on the wood flooring industry and a proud and active member of NWFA. The company specializes in growth planning, process improvement, profit enhancement, and succession planning. Our custom “GRASP” process is designed as a six-month engagement to develop a five-year plan.

growthteams.com

Uniquely beautiful, highly durable palm wood flooring for commercial and residential interiors.

durapalm®

by SMITH & FONG®



VISIT US AT BOOTH 1031

durapalm.com

Exhibitor SHOWCASE



HILLTOP SUPPLY AND HARDWOOD

Booth 125

Revolutionize your work with I-4 Wood: the counter-rotating four-head planetary sander designed for outstanding performance on all hardwood surfaces. Equipped with a powerful 3.5 or 4 HP motor, I-4 Wood combines versatility, power, and ease-of-use. Contact Hilltop Supply and Hardwood to purchase today.

hilltopky.com



HORIZON FOREST PRODUCTS

Booth 201

Your one-stop-shop for: Unfinished flooring and prefinished flooring. **INSTALLATION PRODUCTS:** Adhesives, moisture protection, underlayment, protective overlays, nailers, large machines, small machines. **FINISHING PRODUCTS:** Abrasives, stains, water-based finish, oil-based finish, filler, finishing touches, vents, medallions, moulding. 1,000s of SKUs | 22 Locations | 750,000+ square feet of warehouses.

horizonforest.com



LED COATING SOLUTIONS

Booth 531

Vesting and Heidelberg LED-cured hardwax oils with satin, matte, gloss, semi-gloss, and ultra-matte sheens. Innovative and high-performance finishes designed for flooring, these LED-cured hardwax oils offer instant curing under LED light. They provide durable, eco-friendly protection with zero VOC emissions, enhancing the natural beauty of wood with a smooth, water- and chemical-resistant finish with unlimited color options. Suitable for factory and on-site applications.

ledcoatingsolutions.com



LICO MACHINERY

Booth 919

For more than 25 years, Lico Machinery Inc. has stood out for the quality and reliability of its equipment, the flexibility of its adapted solutions, and its unmatched dedication to customer service. Lico specializes in the design and manufacture of wood flooring equipment ranging from standalone machines to complete solutions.

licoinc.net



LIGNOMAT

Booth 1125

The Ligno-VersaTec is our best meter for floor installers and inspectors. It can be used as a pin and pinless meter or as a RH-insitu humidity-concrete meter. We offer the pinless dual-depth Ligno-VersaTec meter by itself or complete measuring kits V2-M up to V24-KM. Accuracy and dependability are guaranteed with smart design and quality manufacturing.

lignomat.com

UNLEASH THE POWER OF THE I-4 WOOD



*PUSH YOUR BUSINESS
FURTHER WITH THE
FASTEST, MOST
POWERFUL PLANETARY
ON THE MARKET WITH
THE FINEST SCRATCH
PATTERN.*

TEST DRIVE
AT BOOTH
#125

CALL TO ORDER! 859-240-4157



[®]
HYPER
GRINDER

Exhibitor SHOWCASE



LOBA-WAKOL

Booth 133

LOBA Stain: Achieve rich, even color in just one hour with no lap marks and no hassle. Safe, easy to apply, and compatible with Loba water-based finishes, it's the perfect stain made simple for a perfect installation. Available in more than 20 colors.

loba-wakol.com

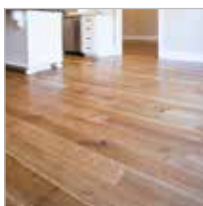

MAXWELL HARDWOOD FLOORING

Booth 517

Maxwell Hardwood Flooring manufactures Legacy Flooring which is our premium line of white oak plank floors that includes a rift and quartered floor as well as a live sawn floor. Legacy Reserve and Legacy Live are available in unfinished $\frac{3}{4}$ " solid and $\frac{5}{8}$ " engineered.

maxwellhardwoodflooring.com



MEKANIKA/HASKO

Booth 716

Our fully automated robotic flooring nester is a unique engineering solution that integrates seamlessly into your process. It modernizes your production line with real-time monitoring and SQL connectivity, ensures consistent performance, strengthens your innovative image, and guarantees every package reflects your commitment to quality and excellence.

mekanika.net



NOFMA

Booth 801

Through the years, NOFMA standards have stood the test of time. NOFMA has been certifying hardwood flooring since 1907 and is the only standard in the industry that assures flooring has been properly kiln dried, manufactured, and graded.

nwfa.org/manufacturing/



NWFA

Booth 801

The National Wood Flooring Association (NWFA) represents all segments of the hardwood flooring industry. NWFA's mission is to unify and strengthen the wood flooring community through technical standards, education, networking, and advocacy. This is accomplished through various programs and services, such as hands-on and online training, our annual Expo, *Hardwood Floors* magazine, and technical standards and publications that are recognized worldwide.

nwfa.org

MAXWELL[®] HARDWOOD FLOORING

FAMILY OWNED & OPERATED SINCE 1992

**MADE IN AMERICA AND
TRUSTED FOR GENERATIONS.**

**Crystal Bridges Museum of American Art, Bentonville, AR | MHF 3/4" x 2 1/4" Clear Red Oak*

When you choose one of our solid floors, you're choosing products grown in American soil and manufactured with American pride. That's more than just a slogan, it's a shift. It's a place where machines wake up before the sun does, where our products carry the fingerprints of our people who craft them, and they know how to make things that last through the generations.

So as our country heads toward its 250th anniversary, we not only honor our history and those who built this country, but we also celebrate the hardworking people like ours, who are building our future, and everyone at our company wants you to know, this isn't just flooring... it's our story and a piece of the country you call home.



real wood
Real Life.

**REAL
AMERICAN
HARDWOOD**



www.maxwellhardwoodflooring.com

Exhibitor SHOWCASE



OLDE WOOD LTD.

Booth 501

European mountain oak captures the refined, dark-toned floors of 17th-century European elite homes. Live sawn from mature wood, these wide planks showcase rich brown tones and distinct sapwood alongside the full range of the wood's natural character – tight grain patterns, saw marks, sound knots, and natural checking.

oldewoodltd.com



PALLMANN

Booth 1301

NEXUS-FUSION is a one-component, solvent- and water-free Silane-Terminated Polymer (STP) adhesive designed for hardwood floors. It offers sound dampening and moisture control of up to 95 percent, reducing the risk of adhesion failure. Experience efficient installation, longer working times, and simple cleanup.

us.pallmann.net



PEACHEY HARDWOOD FLOORING

Booth 1111

Peachey reclaimed is sourced from antique barns and buildings that have been dismantled carefully to maintain as much of the original character as possible, showcasing all characteristics of old buildings that just can't be reproduced with new lumber. Each board carries the unique nail holes, worm holes, mortise and tenon joints, and natural patina.

peacheyhardwoodflooring.com



PIANETA LEGNO FLOORS USA

Booth 607

Pianeta Legno Floors U.S.A. Inc. offers the finest selection of engineered hardwood flooring. We provide custom finishing in our Miami, Florida facility to accommodate all of your wood flooring needs. With more than 300 finish options in European white oak and exotic species, we support large-volume production, in-stock programs, and offer private labeling opportunities.

italianwoodfloors.com



RELIANCE HARDWOOD FLOORING

Booth 207

Herringbone Hardwood Flooring – a floor pattern requiring exact manufacturing to create the unique and beautiful look of herringbone. Offered in white oak, red oak, and hickory. $\frac{3}{4}$ " solid or engineered, unfinished $2\frac{1}{4}$ ", $3\frac{1}{4}$ ", 4", 5", 6" 7", and 8" widths. Custom lengths may be specified based on desired pattern.

reliancehardwoodflooring.com



PIANETA™ LEGN O

FLOORS USA, INC.

www.ItalianWoodFloors.com

6405 Biscayne Boulevard Miami, FL, 33138

P: (305)-576-3141 | F: (305)-576-3151

e-mail: info@plfloors.com

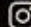
 [pianeta_legno](https://www.instagram.com/pianeta_legno)



PROUD MEMBER OF



nwfa expo

2026

ORLANDO

APRIL 21-23 | NWFAEXPO.ORG

Meet us at Booth #607

nwfa
National Wood
Flooring Association
MEMBER

Exhibitor SHOWCASE

HERRINGBONE

CHEVRON

SHEOGA HARDWOOD FLOORING

Booth 708

Herringbone and chevron patterns require exceptional precision – many contractors cut them on-site to avoid mismatched joints. At Sheoga, our advanced milling technology and slow, careful production ensure perfect angles, consistent dimensions, and flawless alignment. Trust our expertise to deliver factory-crafted herringbone and chevron flooring with superior accuracy and craftsmanship every time.

sheogaflooring.com



STAUFA USA

Booth 924

PUM-950 Power-Mastic® is a high-strength, urethane-based wood flooring adhesive engineered for professional installation. Free of isocyanates and solvents, it delivers exceptional shear strength, long open time, and strong green grab without flash time. Its non-slump formula ensures reliable transfer and consistent performance on demanding hardwood projects.

staufusa.com



SWIFFER

Booth 332

Mop smarter with Swiffer PowerMop Wood, an all-in-one mopping system that gives you a mop and bucket clean in half the time*. The pad has more than 300 Gentle-Glide strips that absorb dirt and grime – even in grooves and grout. The lemon scented QuickDry cleaning formula dries up to 2X faster**.

**vs. mop and bucket - includes cleaning and drying time*

***vs. Mr. Clean All Purpose Cleaner*

swiffer.com



TAYLOR ADHESIVES

Booth 1416

Ridgeline leads the industry with unmatched protection for wood floors. It creates an unlimited moisture vapor barrier, resists alkalinity, and significantly reduces impact and sound transmission. With no moisture-related testing required, Ridgeline streamlines installation, saving time and money while delivering superior performance.

tayloradhesives.com



TISE - THE INTERNATIONAL SURFACE EVENT

Booth 318

The International Surface Event (tise) 2027 is where the surfaces industry unites to kick off the year. Discover trends, styles, and innovations shaping 2027, connect with industry leaders, and explore an enhanced experience designed to inspire and deliver results. Two neighborhoods. One event. All angles covered.

intlsurfaceevent.com

STAUF®

— EST. 1828 —

SOLVA-MASTIC®
WFR930

**No Hollow Spots.
Effortless Cleanup - No Etching.
Unmatched Strength.**

Stick With What Works



www.staufusa.com



TOP STEP VENTS

Booth 1020

Our decorative flush-mount vents are crafted from durable ¼" steel and designed to sit perfectly level with your floor. Made to stand out, they add a bold, finished look to solid and engineered wood flooring. Proudly manufactured in Utah, each vent combines quality craftsmanship with modern, eye-catching design.

topstep.biz



UNION TOOL CORPORATION, THE

Booth 417

This system includes our core board feeder, hot melt roller coater, lay-up conveyor, rotary laminator, and flying cutoff saw. Our hot melt roller coater applies a uniform coating of PUR adhesive to plywood cores. Thin lamellas are placed on top of the coated cores before they are laminated together using the rotary laminator. Boards then are cut to specific lengths by our flying cutoff saw.

uniontoolcorp.com



WAGNER METERS

Booth 1016

Floor Sentry, the embedded wood floor data logger, monitors wood floor and subfloor temperature and relative humidity conditions through its Bluetooth connection with the Wagner Sentry app. Monitor real-time data, receive instant alerts for threshold breaches, effortlessly share detailed reports, and maintain precise control over your wood floor and subfloor environments.

wagnermeters.com



WOODWISE

Booth 1101

WOODWISE is showcasing its extensive line of wood fillers, maintenance products, and tools and accessories for the wood flooring industry. Experienced Woodwise reps will be on hand to help answer all of your questions and provide product demos throughout the NWFA Expo. Available throughout North America.

woodwise.com

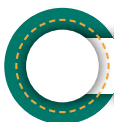

IGNITE YOUR PASSION





THE
**UNION TOOL
CORPORATION**

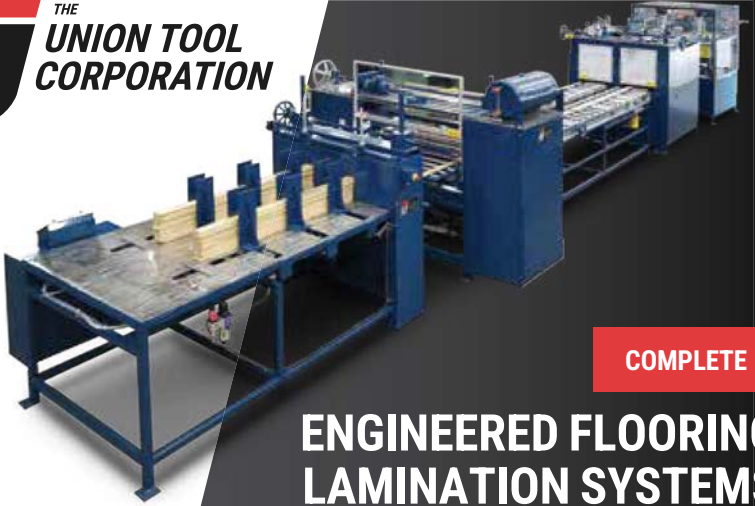

COMPLETE

ENGINEERED FLOORING LAMINATION SYSTEMS

MAXIMIZE PRODUCTION OUTPUT WHILE MAINTAINING PRECISION QUALITY CONTROL



We offer our engineered flooring lamination system in a variety of different sizes



Single lane or dual lane options for specific production requirements



Configurations for piece by piece or continuous types of laminations

VISIT US AT NWFA BOOTH #417

Floorplan

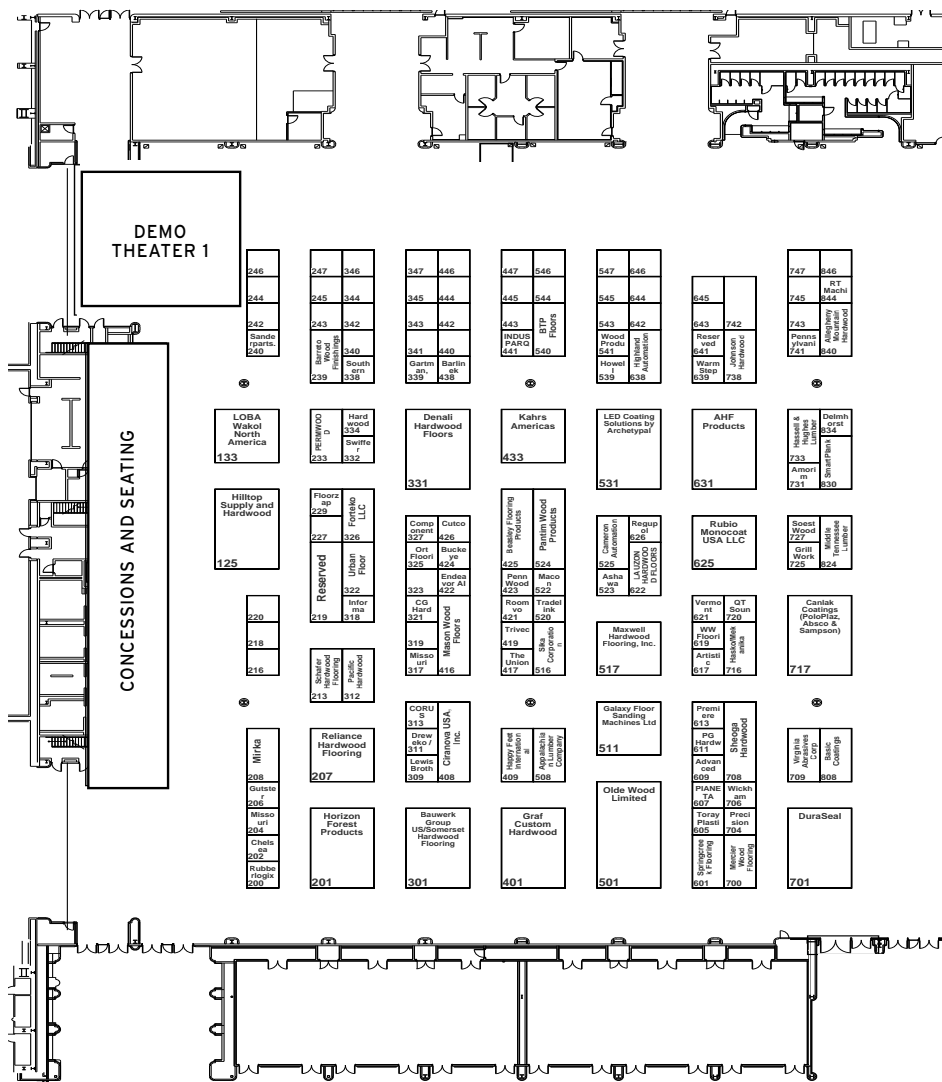

THANK YOU
TO OUR
MOBILE APP
SPONSORS

Bona[®]
SEE US AT BOOTH #901

MULLICAN[®]
— HARDWOOD FLOORING —
SEE US AT BOOTH #1217

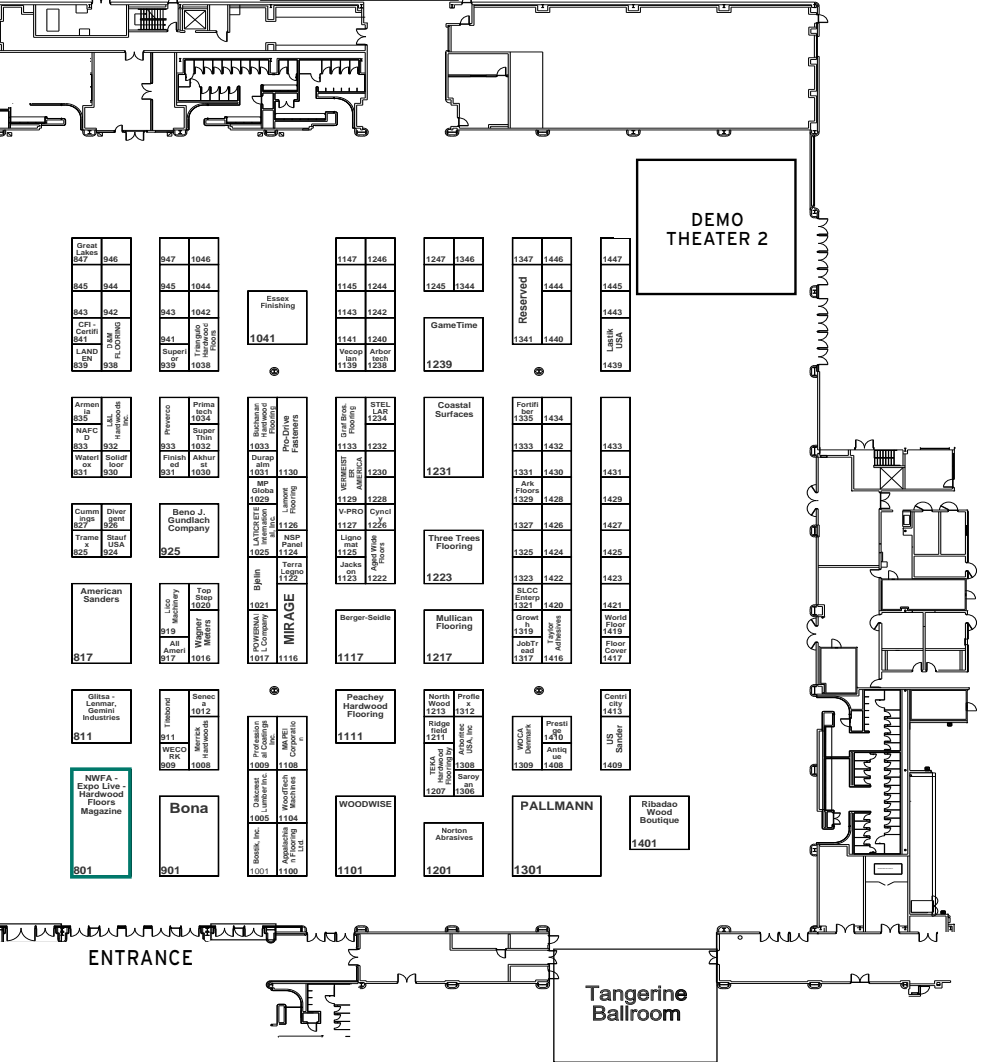

FLOOR PLAN ALSO AVAILABLE ON THE NWFA EXPO APP:

Download the 2026 Mobile App from iTunes or Google Play.

Sightseeing

IN THE SUNSHINE STATE

Everyone knows about Florida's beaches and Orlando's theme parks. Here, local NWFA members offer additional recommendations of what to see and do should you decide to add on some days to your Expo trip.



PHOTOS COURTESY OF ANDREW

“Try to make it to **Cape Canaveral** on the Space Coast.”

- **Bob Goldstein, Vermont Natural Coatings**

“Since we are in theme park central, any park is a good option. If you are into historic sites, a day trip to St. Augustine is good. Beaches on either side of the peninsula are waiting for you. There also are loads of **scuba and snorkling sites** on the east coast.

Plus, we have flat boat fishing and deep-sea fishing opportunities.”

- **Lenny Hall, Endurance Floor Company Inc.**



“If someone is a history buff, rent a car and go to **St. Augustine**, since it's the oldest city in our nation. If you just want to spend time with the kids, then you're in the perfect place in Orlando to go to Disney or Universal Studios.”

- **Andy Campbell, DNA Floor Surgeons Inc.**



“A visit to NASA/Kennedy Space Center. **Universal Studios Orlando's Epic Universe** (ideally with express passes because the lines for the rides can be one hour or more). Take an air boat ride, which always is a unique way to see Florida's natural wetlands.”

- **Rob Mercier, Walk on Wood Inc.**



THANK YOU TO THE FOLLOWING PARTNERS FOR ADVERTISING WITH US.

Allegheny Mountain Hardwood Flooring	47	Lico Machinery	27
Antique Building Solutions	41	Lignomat	39
Appalachian Lumber Co.	23	Loba-Wakol	13
Armenia Mountain Plank & Panel	33	Maxwell Hardwood Flooring Inc.	57
Bauwerk Group North America	31	NOFMA	IBC
Berger-Seidle	BC	NWFA.....	30, 44
Bjelin	49	Olde Wood Limited	IFC
Bona US	5	Pallmann	1
Bruce®, a brand of AHF Products	19	Peachey Hardwood Flooring	7
Canlak Coatings	51	Pianeta Legno Floors USA Inc.	59
CORUS Fastening	4	Reliance Hardwood Flooring	35
Delmhorst Instrument Co.	25	STAUF USA	61
Durapalm by Smith & Fong	53	Swiffer	11
Essex Finishing	9	Taylor Adhesives	29
GameTime Coatings	6	tise - The International Surface Event	22
Gemini Industries	37	Top Step Vents	43
Growth Team Strategies	8	Union Tool Corporation, The	63
Hilltop Supply and Hardwood	55	Wagner Meters	17
Horizon Forest Products	15	Woodwise	2
LED Coating Solutions by Archetypal	45		

INTERESTED IN ADVERTISING WITH **HARDWOOD FLOORS** MAGAZINE?

Contact *Hardwood Floors*
magazine today or visit
hardwoodfloorsmag.com
to learn more.



Katie Schenk
Advertising & Brand Growth Director
katie.schenk@nwfa.org
314.488.4669

TRUSTED

Across the Land

Quality Made.
Close to home.



TRUSTED MANUFACTURERS

- AHF Products
- Anthony Oak Flooring
- Appalachian Lumber Co.
- Bluegrass Wood Products
- Buchanan Hardwoods / Elite Brand Flooring
- Carlisle Wide Plank Floors
- Carroll Hardwood Co.
- Chelsea Plank Flooring by Frame Industries, Inc.
- Cumberland Lumber & Mfg.
- Graf Custom Hardwood
- Hassell & Hughes Lumber Co.
- Henry County Hardwoods
- Lauzon Flooring
- Lewis Brothers Lumber Co.
- Maine Traditions Flooring / WW Flooring Group
- Maxwell Hardwood Flooring
- Merrick Hardwoods
- Middle TN Lumber Co.
- Missouri Hardwood / Hardwoods of Missouri
- Mullican Flooring
- Ouachita Hardwood Flooring
- Premier Hardwood Products
- Reliance Hardwood Flooring
- Roberts Wood Products
- Sheoga Hardwood Flooring
- Smith Flooring Inc.
- Somerset Hardwood Flooring
- Superior Hardwood Flooring by Herwynen Saw Mill Ltd.
- T&F Lumber Co.



100 YEARS AND COUNTING

NOFMA members are located in the U.S. and Canada.



SUSTAINABLE AND SAFE

Trust that your floors are safe, sustainable, and sound.



SETTING THE INDUSTRY STANDARD

NOFMA assures wood flooring has been properly kiln dried, manufactured, and graded.

BECOME NOFMA CERTIFIED

Join the network

WHEN QUALITY MATTERS,
CONTACT AN NWFA/NOFMA MANUFACTURER.

NWFA.ORG/MANUFACTURING/ • 800.422.4556



VIEW MORE

1926 – 2026

Together for **YOU**
Together with

THANK YOU FOR
100
YEARS
OF PASSION FOR
WOOD FLOORING

100
YEARS | **bergerseidle**[®]

Meet us at Booth #1117

nwfa expo

2026

ORLANDO

APRIL 21-23 | NWFAEXPO.ORG