

nwfa expo

Ignite YOUR PASSION

APRIL 21-23, 2026 | ORLANDO



EXHIBITOR *Showcase* GUIDE

THE ONLY TRADE SHOW
IN THE WORLD DEDICATED
EXCLUSIVELY TO
Wood Flooring

Brought to you by:

hardwood floors

THE MAGAZINE OF THE NATIONAL WOOD FLOORING ASSOCIATION



LEARN MORE AT NWFAEXPO.ORG

OldeWood

L I M I T E D

VISIT US AT EXPO
BOOTH #501

LUXURY WIDE PLANK FLOORING

SOLID • ENGINEERED • UNFINISHED • PREFINISHED

MANUFACTURED IN AMERICA



866-208-9663 | OldeWoodLtd.com



PALLMANN®

WOOD FLOORS. PROTECTED.

SUBFLOOR PERFORMANCE SYSTEMS

**INSTALL WITH STRENGTH
AND CONFIDENCE**

SCAN HERE



TO LEARN MORE



BOOTH #1301

US.PALLMANN.NET

f **@** pallmannusa

UZIN UTZ®

WOODWISE®

PROFESSIONAL HARDWOOD FLOORING PRODUCTS



Come By and Say Hi at Booth 1101!

THE RIGHT WOOD FILLERS FOR EVERY JOB.



Trusted by flooring professionals throughout North America, **WOODWISE** wood fillers are the gold standard for hardwood flooring applications and are supported by a full line of wood care products, tools and accessories.

+ WOOD CARE PRODUCTS



& TOOLS & ACCESSORIES

To learn more or find a dealer near you, go to woodwise.com or call us at **425-869-0859**.

WORK WISELY.
with



WOODWISE®

Design Hardwood Products, Inc. • Redmond, WA





CONTENTS

| | |
|---|----|
| Chair's Welcome | 10 |
| NWFA Expo Sponsors | 12 |
| NWFA Expo App and Wi-Fi Instructions | 14 |
| Expo Schedule | 16 |
| Expo Exhibitor List by Name | 24 |
| Expo Exhibitor List by Product Category | 32 |
| Expo Exhibitor Showcase | 46 |
| Trade Show Floor Plan | 64 |
| Sightseeing in the Sunshine State | 66 |
| Ad Index | 68 |

nwfa expo

'26

Ignite YOUR PASSION

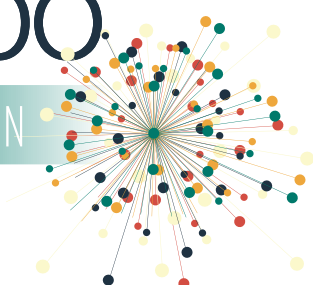

THANK YOU TO OUR PUBLISHING PARTNERS





CORUS

Your Complete Flooring Supply Partner.

Fasteners Tools Cordless Adhesives
Sawblades Strapping more

One order. One shipment. Nationwide reach.



800-255-7209



corusfastening.com

VISIT US AT BOOTH
#901



Benefits of using **The Bona System**[®]

- Training and educational opportunities available
- Responsive technical support when needed
- Solutions for every flooring need
- Support for the lifetime of the floor
- Strong homeowner brand awareness of Bona



SCAN TO
Learn More
About Every
Step of The
Bona System!

Bona.com



Bona[®]



COMMERCIAL | RESIDENTIAL

COATINGS

PROFESSIONAL POLYURETHANE



GAMETIMECOATINGS.COM



Happy Valley
QUICK SHIP

Quick Ship in
Two Weeks or Less



Big Valley
SEMI CUSTOM

Semi-Custom in
Four Weeks or Less



Blue Sky
FULLY CUSTOM

Fully-Custom
The Sky's the Limit!

Preview our new quick-ship and
custom wood flooring programs.

Booth 1111



PEACHEY
HARDWOOD FLOORING

The Beauty of Nature. Perfected.



Drive your company to greater growth and profitability in 2026.



Our Services

Wood Flooring Edge is our industry focused one-on-one coaching and consulting service. Members get expert advice and business coaching on a monthly basis.

Wood Flooring Exchange is our industry-specific business owner peer group program. Members share business challenges and learn the best practices from other business owners.

Expo Special:
Get your first month of coaching **FREE!**

"Growth Team Strategies helped us design a comprehensive and sustainable path forward. They are hands down the best investment we have made in our business to date."

-Mike Somodean, *Roswell Flooring*

Get started now! Scan the QR code to schedule a meeting with Doug.

www.growthteams.com



ESSEX

FINE WOOD FINISHING



Black Walnut and European Oak Flooring
Custom Finished and Private Labeled For You

We are way beyond a flooring company. Our untraditional approach is aimed at offering a wide range of privately labeled custom flooring. Our factory in New Jersey is specifically designed for complex finishes.

Contact us to curate your custom flooring selections!



CHAIR'S WELCOME



This year marks the 40th anniversary of the NWFA Wood Flooring Expo. When the first NWFA Convention (as it was known back then) took place in St. Louis, Missouri, in 1986, there were fewer than 200 attendees. Fast forward to today, where more than 2,000 wood flooring professionals can be found walking around the show floor.

We are proud to host the only trade show in the world dedicated exclusively to wood flooring. For four decades, the NWFA Expo has set the standard. As we mark this milestone, we raise it higher.

Throughout this week, you can experience more than 30 expert-led education sessions, live technical demonstrations, and more than 250 exhibitors showcasing new products and proven solutions.

Reconnect with old friends and meet some new ones at one of our many networking events. There is something for everyone with the New Member Reception, Distributor and Manufacturer Reception, Women's Industry Network Session, NWFA Emerging Leaders Reception, and the Grand Finale Celebration, to name a few.

This is where the industry advances. I hope the time you spend here in Orlando will equip you with everything you need to "Ignite Your Passion."

Steve Brattin
Chair, NWFA



Swiffer®

POWER MOP

WOOD



MOP SMARTER

**CLEANS FLOORS IN HALF
THE TIME VS. MOP & BUCKET***



Fine mist spray with
QUICKDRY formula.™

**DRIES UP TO
2X FASTER****



300+ gentle glide
ABSORB + LOCK™ STRIPS



Disposable Cloths
**MAKE CLEANUP
EASY**

*Vs. mop and bucket – includes cleaning and drying time.
**Vs. Mr. Clean® All Purpose Cleaner.

©2026 P&G

Sponsors

(as of 3.10.26)

Signature



Partner

- DuraSeal
- Hilltop Supply and Hardwood
- Mullican Flooring
- Sheoga Hardwood Flooring

Supporter

- Bostik, Inc.
- Chelsea Plank Flooring
- CORUS Fastening
- Elavon by U.S. Bank
- Lägler
- LATICRETE International Inc.
- LAUZON Hardwood Floors
- North American Association of Floor Covering Distributors
- Peachey Hardwood Flooring
- Pro-Drive Fasteners
- RW Supply & Design
- Wagner Meters

Friend

- Allegheny Mountain Hardwood Flooring
- Armenia Mountain Plank & Panel
- Coastal Surfaces
- Delmhorst Instrument Co.
- D&M Flooring
- Howell Hardwood Flooring
- Lambright Flooring
- Maxwell Hardwood Flooring Inc.
- Proflex Products Inc.
- Rubio Monocoat USA LLC
- SVB Wood Floors
- WW Flooring Group

Thank You
TO OUR SPONSORS
FOR YOUR SUPPORT



Loba[®]
On Top!

WAKOL[®] 
Pursuing excellence unites



**LOBA WAKOL NORTH AMERICA
BOOTH #133**





DOWNLOAD THE NWFA EXPO APP FOR FREE

CUSTOMIZE YOUR EXPO EXPERIENCE



Search for “NWFA Expo” to download from iTunes or Google Play.

Have access to everything Expo related at your fingertips when you download the NWFA Expo mobile app. The app houses everything from the education and special events schedule to speaker bios and the exhibitor list. You can customize your schedule and bookmark the sessions and exhibitors you want to be sure not to miss.

Don't forget to allow push notifications so you receive show specials and updates throughout NWFA Expo. You can update your preferences in the settings of your phone's app manager.

FOLLOW THESE STEPS TO USE THE APP:

- Download the mobile app by searching for NWFA Expo 2026 in your iTunes or Google Play app store.
- Once the app downloads, open it on your mobile device.
- Enable push notifications and customize your schedule to make the most of your experience at Expo.

APP SPONSORED BY:

Bona[®]

SEE US AT BOOTH #901



SEE US AT BOOTH #1217

WI-FI INSTRUCTIONS

When you go into your wireless settings, search for the network “EXPO2026.” Select the network and enter the case-sensitive password:

NETWORK NAME: EXPO2026
PASSWORD: OldeWood (case sensitive)

WiFi sponsored by:  **OldeWood**
LIMITED

SEE US AT BOOTH #501



HORIZON
FOREST PRODUCTS

YOUR ONE STOP SHOP

Your One-Stop-Shop for: Unfinished Flooring, Prefinished Flooring, Waterproof Flooring.

INSTALLATION PRODUCTS: Adhesives, Moisture Protection, Underlayment, Protective
Overlays, Nailers, Large Machines, Small Machines. FINISHING PRODUCTS: Abrasives, Stains,
Water Based Finish, Oil Based Finish, Filler, Finishing Touches, Vents, Medallions, Moulding.

EVERYTHING YOU NEED

Your One-Stop-Shop for: Unfinished Flooring, Prefinished Flooring, Waterproof Flooring.

INSTALLATION PRODUCTS: Adhesives, Moisture Protection, Underlayment, Protective
Overlays, Nailers, Large Machines, Small Machines. FINISHING PRODUCTS: Abrasives, Stains,
Water Based Finish, Oil Based Finish, Filler, Finishing Touches, Vents, Medallions, Moulding.

Your One-Stop-Shop for: Unfinished Flooring, Prefinished Flooring, Waterproof Flooring.

INSTALLATION PRODUCTS: Adhesives, Moisture Protection, Underlayment, Protective
Overlays, Nailers, Large Machines, Small Machines. FINISHING PRODUCTS: Abrasives, Stains,
Water Based Finish, Oil Based Finish, Filler, Finishing Touches, Vents, Medallions, Moulding.

Your One-Stop-Shop for: Unfinished Flooring, Prefinished Flooring, Waterproof Flooring.

INSTALLATION PRODUCTS: Adhesives, Moisture Protection, Underlayment, Protective
Overlays, Nailers, Large Machines, Small Machines. FINISHING PRODUCTS: Abrasives, Stains,
Water Based Finish, Oil Based Finish, Filler, Finishing Touches, Vents, Medallions, Moulding.

1,000'S of SKUS | **22** LOCATIONS | **750,000+** SF of WAREHOUSES



VISIT US

CONTACT US TODAY!

Find your local branch: HorizonForest.com/contact



HORIZON
FOREST PRODUCTS

Schedule

(as of 3.10.26)

TUESDAY, APRIL 21

7:00 a.m. - 8:00 p.m. **Registration Open**

8:00 a.m. - 8:00 p.m. **Exhibitor Set-up**

8:00 a.m. - 3:00 p.m.

PRE-EXPO SYMPOSIUM

Data Collection: Building Defensible Inspection Reports

Jon Namba, Namba Services and Carl Mattingly, GalleherDuffy

Report Writing: Understanding Audience and Purpose

Cathy Duncan, EZ Report Writing

Legal Considerations: Ethics and Litigation Readiness

Barbara Dunn, Barbara Dunn Law and Billy Simmons, ITAC International

SPECIAL ADD-ON SESSIONS

8:30 a.m. - 3:30 p.m.

NWFA Certified Sales Advisor Session

Ashley Do Carmo, Brown Oaks Flooring, NWFA Certified Sales Advisor, and Regional Instructor; and Scott Taylor, NWFA Certified Wood Flooring Inspector and Regional Instructor

1:30 p.m. - 3:00 p.m.

Success and Succession

Doug Howard, Growth Team Strategies

3:30 p.m. - 4:15 p.m.

NEW MEMBER RECEPTION

Welcome to the NWFA! Join us to connect with fellow members, share insights, and learn how the association can support your business - all in a relaxed, welcoming setting.

4:30 p.m. - 5:45 p.m.

IGNITE YOUR PASSION OPENING SESSION

Join the NWFA at our opening session for an industry update, NWFA Wood Floor of the Year Awards, and more.

6:00 p.m. - 7:30 p.m.

SPARK RECEPTION

After the opening session, connect with fellow professionals and rekindle old friendships.

Expo Social Circle: Meet the Faces Behind the Posts | Meet your online connections at the Expo Social Circle, a relaxed gathering where social media conversations turn into real-world relationships. Connect with the people behind the posts to share insights, spark collaborations, and strengthen the wood flooring community - one conversation at a time.

When Using a Concrete
Meter, Use One That's

**2X MORE
ACCURATE**



For the 9 commonly used
concrete mix designs we
tested, the C555's readings
were significantly closer to
oven dry results.

Learn more:
wmmeters.com/3tK492Y



**WAGNER
METERS**



wmmeters.com/3tK492Y

Schedule

(as of 3.10.26)

WEDNESDAY, APRIL 22

7:30 a.m. - 9:30 a.m.

Morning Coffee

7:30 a.m. - 6:00 p.m.

Registration Open

SESSIONS

8:00 a.m. - 9:00 a.m.

Parquet Patterns: Building Custom Sleds

NWFA Regional Instructors

Using AI to Streamline Processes and Create Workplace Efficiency

Reid Lambright, Lambright Flooring; Andy Iamaio, Centricity; and Ryan McCord, Endeavor

To Fill or Not to Fill: The Science of Wood Floor Gapping

Mike Dittmer and Rob Johnson, Bona

When the Stain Isn't What They Expected: Avoiding Color Disasters

Toby Merrill, DuraSeal

9:15 a.m. - 10:15 a.m.

Layout and Installation of Custom Parquet Patterns

NWFA Regional Instructors

8 Leadership Skills for Wood Flooring Success:

Being the Leader Your Company Deserves

Doug Howard, Growth Team Strategies

Jobsite Troubleshooting: Solving Common Issues to Prevent Call Backs

Chad Bulen, Bostik and Tyler Powell, AllWell Agency

Design Intent and Jobsite Realities: Sharing Perspectives for Better Outcomes

Karen Asprea, Asprea Studio and Robyn Branch, Robyn Branch Design; Moderated by Lawrence Skutelsky, PID Floors

9:15 a.m. - 10:15 a.m.

WOMEN'S INDUSTRY NETWORK EVENT

Confidence in Action: Owning Your Superpower | Join us for WIFI's exclusive event, designed to empower and connect women in the floor covering industry. This interactive session will feature both a panel and tabletop discussion focused on pinpointing what your strong suit is and how to use those skills to stand out.

Brenda Cashion, UCX; Ashley Do Carmo, Brown Oaks Flooring; and Julie Russell, Gemini Industries; Moderated by Renee Tester, Kährs

10:30 a.m. - 5:00 p.m.

Trade Show Open | Exhibitor Demos | Concessions Open

4:00 p.m. - 5:00 p.m.

IT'S 5 O'CLOCK SOMEWHERE HAPPY HOUR

Grab a drink and network with peers on the trade show floor.

5:00 p.m. - 6:15 p.m.

DISTRIBUTOR & MANUFACTURER RECEPTION

Build new business relationships to expand your product reach.

5:30 p.m. - 6:45 p.m.

EMERGING LEADERS RECEPTION

Attendees aged 40 and younger are invited to attend.



Bruce®

WE'VE GOT UNFINISHED BUSINESS

Bruce®, the preferred partner in hardwood, now offers Bruce Unfinished™ hardwood—available in solid white and red oak, as well as a diverse range of unfinished engineered options. Made in the USA, Bruce hardwood floors have been trusted by trade professionals for over 150 years.

- Select Grade
- Square edges and ends for a seamless site finish
- Precision milled for a fast, easy installation

Bruce - the #1 most trusted name in hardwood



MADE IN THE USA
with U.S. and Global Components

See us at the
NWFA Expo
Booth #631

www.bruce.com 1-855-243-2521

*See warranty for additional details ©2026 AHF, LLC. All trademarks are owned by AHF, LLC, or its subsidiaries or affiliates.

Schedule



THURSDAY, APRIL 23

7:30 a.m. - 9:30 a.m.

Morning Coffee

7:30 a.m. - 3:00 p.m.

Registration Open

SESSIONS

8:00 a.m. - 9:00 a.m.

Sanding a Custom Parquet Pattern

NWFA Regional Instructors

Reduce HR Worries and Woes

Katie Magoon, People Solutions Center

Reading Commercial and Residential Specs

Billy Simmons, ITAC International

Social Media That Works on the Jobsite

Joe Avila, Huggins Wood Floors; Cesar Cardona, Cardona Flooring; Alex Hamilton, Grain Design Flooring; and Phil Valenti, Valenti Flooring; Moderated by Bridget Norlie, NWFA

9:15 a.m. - 10:15 a.m.

Staining and Finishing a Custom Parquet Floor

NWFA Regional Instructors

Freedom First: How Flooring Companies Scale Without Owner Dependency

Justin Shaw, Driven for Growth

Preserving the Past: An Introduction to Historic Wood Floor Restoration and Preservation

Sprigg Lynn, Universal Floors; Todd McDonald, Maple Ridge Handscraped; and Kevin Mullany, Benchmark Wood Floors

Channeling Your Inner Artist as a Craftsman

Jakko Woudenberg, the Dutch Wood Artist



THURSDAY, APRIL 23

EMERGING LEADERS PANELS

8:00 a.m. - 9:00 a.m.

Inside the Spec Panel: A Conversation Between A&D and the Wood Flooring Industry

Allison Watson Grim, Watson Design; Malcolm Jones, MAJ Architecture + Design; Amber C. Morales, A.Clore Interiors; and Lawrence Skutelsky, PID Floors; Moderated by Stephanie Owen, NWFA

9:15 a.m. - 10:15 a.m.

The Future Floor Panel & Q+A: Insights from the Next Generation of Industry Leaders

Izaiah Barrow, iSandNewYork LLC; Matt Bruno, Palermo Floor Inc.; and Alex Hamilton, Grain Design Flooring; Moderated by Kirk Roberts, Bona

10:30 a.m. - 3:00 p.m.

Trade Show Open | Exhibitor Demos | Concessions Open

3:00 p.m. - 4:30 p.m.

GRAND FINALE

Join us as we celebrate another successful NWFA Expo.

3:00 p.m. - 9:00 p.m.

Exhibitor Tear-Down

FRIDAY, APRIL 24

7:00 a.m. - 1:30 p.m.

NERF GOLF TOURNAMENT

Join us for the 2nd Annual NWFA Education & Research Foundation Golf Tournament, hosted at Disney's Palm Golf Course. This special event brings together industry professionals while supporting the NWFA's mission of attracting and training the next generation of flooring contractors and business owners.

8:00 a.m. - 12:00 p.m.

Exhibitor Tear-Down

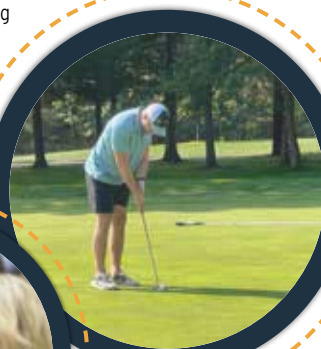



SURFACES

Design.
Innovation.
Collaboration.
All Angles
Covered.

Visit us at the NWFA Expo Booth #318

SAVE THE DATE tise 2027

Expo: February 2-4, 2027
Education: February 1-4, 2027
Mandalay Bay Convention Center
Las Vegas, NV



Official SURFACES
Sponsors



SCAN FOR THE
LATEST UPDATES!

EST 1982



APPALACHIAN
- LUMBER -
• CUSTOM WOOD PRODUCTS •

Herringbone or Chevron?

Both herringbone and chevron flooring patterns add a nice touch of luxury and sophistication to interiors. Herringbone flooring planks are cut at 90 degree angles to create a distinct zig-zag pattern, while most chevron floors are cut to 45 degree angles. Other custom angles are available as well.



[View Online](#)

Classic. Timeless. Available in a wide variety of wood species.

Domestic

- ✓ Alder
- ✓ American Cherry
- ✓ American Cypress
- ✓ Aromatic Cedar
- ✓ Ash
- ✓ Australian Cypress
- ✓ Beech
- ✓ Birdseye Maple
- ✓ Curly Maple
- ✓ Domestic New Heart Pine
- ✓ Douglas Fir
- ✓ Euro Beech
- ✓ Hard Beech
- ✓ Hickory
- ✓ Locust
- ✓ Pecky Cypress
- ✓ Poplar
- ✓ Quartered Sawn Red Oak
- ✓ Quartered White Oak
- ✓ Red Birch
- ✓ Red Oak
- ✓ Rift & Quartered Red Oak
- ✓ Rift & Quartered White Oak
- ✓ Rift White Oak
- ✓ Walnut (Steamed)
- ✓ White Oak
- ✓ White Pine
- ✓ Wormy Chestnut
- ✓ Wormy Maple
- ✓ Wormy Red Oak
- ✓ Yellow Birch
- ✓ Yellow Pine

Exotic

- ✓ Brazilian Cherry
- ✓ Caribbean Heart Pine
- ✓ Cumaru (Brazilian Teak)
- ✓ IPE (Brazilian Walnut)
- ✓ Santos Mahogany
- ✓ Sapele
- ✓ Tigerwood

Exhibitors

LISTED BY NAME
(as of 3.10.26)

Companies in **TEAL** are advertisers in this guide and the April/May issue of *Hardwood Floors* magazine.
For descriptions of what they are displaying at the NWFA Wood Flooring Expo, see the Expo Exhibitor Showcase starting on page 46.

| COMPANY NAME | BOOTH # | COMPANY NAME | BOOTH # |
|---|-------------|---|-------------|
| Advanced Adhesive Technologies, LLC. | 609 | CG Hardwood Molding | 321 |
| AFT - Advanced Flooring Technology | 1327 | Chelsea Plank Flooring | 202 |
| Aged Wide Floors | 1222 | Ciranova USA Inc. | 408 |
| AHF Products | 631 | Coastal Surfaces | 1231 |
| Akhurst Machinery Inc. | 1030 | Component Solutions | 327 |
| Alchemy Home Supply | 443 | CORUS Fastening | 313 |
| All American Wood Register Co. | 917 | Cross Country Hardwood LLC | 444 |
| Allegheny Mountain Hardwood Flooring | 840 | Cummings Lumber Company, Inc. | 827 |
| American Sanders | 817 | Cutco | 426 |
| Amorim Cork Solutions | 731 | D&M FLOORING | 938 |
| Anthony Vandyck Inc. | 1331 | Delmhorst Instrument Co. | 834 |
| Antique Building Solutions | 1408 | Denali Hardwood Floors | 331 |
| Appalachian Flooring Ltd. | 1100 | Divergent Adhesives | 926 |
| Appalachian Lumber Company | 508 | Dreweko / T&G Wood | 311 |
| Arboritec USA Inc | 1308 | Durapalm | 1031 |
| Arbortech Tools | 1238 | DuraSeal | 701 |
| Ark Floors | 1329 | Ecco Enterprises Ltd | 219 |
| Armenia Mountain Plank & Panel | 835 | Endeavor Al | 422 |
| Artistic Finishes Inc. | 617 | Essex Finishing | 1041 |
| Ashawa Bay Hardwood Floors | 523 | Finished Edge Technology LLC | 931 |
| Barlinek Floors | 438 | Floor Covering Industry Foundation | 1417 |
| Barreto Wood Finishings | 239 | Floorzap | 229 |
| Basic Coatings | 808 | Forteko LLC | 326 |
| Bauwerk Group US/Somerset Hardwood Flooring | 301 | Fortifiber Flooring Products | 1335 |
| Beasley Flooring Products | 425 | Galaxy Floor Sanding Machines Ltd. | 511 |
| Berger-Seidle | 1117 | GameTime Coatings | 1239 |
| Bjelin | 1021 | Gartman LLC | 339 |
| Bona | 901 | Glitsa - Lenmar, Gemini Industries | 811 |
| Bostik Inc. | 1001 | Graf Bros. Flooring | 1133 |
| BTP Floors | 540 | Graf Custom Hardwood | 401 |
| Buchanan Hardwood Flooring Co. LLC | 1033 | Graf Wood | 1228 |
| Buckeye Hardwoods | 424 | Great Lakes Custom Tool Mfg. Inc. | 845 |
| Cameron Automation | 525 | Grill Works Inc. | 725 |
| Canlak Coatings (PoloPlaz, Absco, & Sampson) | 717 | Growth Team Strategies | 1319 |
| Centricity | 1413 | Gundlach Tools | 925 |
| CFI - Certified Flooring Installers | 841 | Gutster Tools | 206 |

Moisture Meters for Lumber, Woodworking & Flooring

JX-20 & JX-30



- Fast and reliable readings
- Dashboard-like backlit display
- Export readings and generate reports via EDGE[®] app
- 2-year warranty



51 Indian Lane East
Towaco, NJ 07082



www.delmhorst.com



877-DELMHORST (335-6467)



info@delmhorst.com

Exhibitors

LISTED BY NAME
(as of 3.10.26)

| COMPANY NAME | BOOTH # |
|--|-------------|
| Happy Feet International | 409 |
| Hardwood Solutions Inc. | 334 |
| Hasko/Mekanika | 716 |
| Hassell & Hughes Lumber Co., Inc. | 733 |
| Highland Automation | 638 |
| Hilltop Supply and Hardwood | 125 |
| Horizon Forest Products | 201 |
| Howell Hardwood Flooring | 539 |
| Indusparquet USA | 441 |
| Jackson Building Products | 1123 |
| JobTread | 1317 |
| Johnson Hardwood | 738 |
| Kährs Americas | 433 |
| L&L Hardwoods Inc. | 932 |
| Lamont Flooring | 1126 |
| Landen Strapping Corporation | 839 |
| Lastik USA | 1341 |
| LATICRETE International Inc. | 1025 |
| Lauzon Hardwood Floors | 622 |
| LED Coating Solutions by Archetypal | 531 |
| Lewis Brother's Lumber Company Inc. | 309 |
| Lico Machinery | 919 |
| Lignomat USA Ltd. | 1125 |
| Loba-Wakol North America | 133 |
| Macon Hardwood | 522 |
| MAPEI Corporation | 1108 |
| Mason Wood Floors | 416 |
| Maxwell Hardwood Flooring Inc. | 517 |
| Mercier Wood Flooring Inc. | 700 |
| Merrick Hardwoods | 1008 |
| Middle Tennessee Lumber | 824 |
| MIRAGE | 1116 |
| Mirka | 208 |
| Missouri Hardwood Products | 317 |
| Missouri Walnut LLC | 204 |
| MP Global Products LLC | 1029 |
| Mullican Flooring | 1217 |

| COMPANY NAME | BOOTH # |
|---|-------------|
| Next Floor Inc. | 1323 |
| No. Amer. Assn of Floor Covering Distributors | 833 |
| North Wood Flooring LLC | 1213 |
| Norton Abrasives | 1201 |
| NSP Panels | 1124 |
| NWFA/Hardwood Floors Magazine/NOFMA | 801 |
| Oakcrest Lumber Inc. | 1005 |
| Olde Wood Limited | 501 |
| Ort Flooring & Lumber LLC | 325 |
| Pacific Hardwood | 312 |
| PALLMANN | 1301 |
| Pantim Wood Products | 524 |
| Peachey Hardwood Flooring | 1111 |
| Penn Wood Products Inc. | 423 |
| Pennsylvania Lumbermen's Mutual Insurance Company | 741 |
| People Solutions Center | 247 |
| Permwood | 233 |
| PG Hardwood Flooring Inc. | 611 |
| Pianeta Legno Floors USA Inc. | 607 |
| Pownail Company | 1017 |
| Precision Flooring Products Inc. | 319 |
| Premiere Finishing & Coating | 613 |
| Prestige Enterprise International Inc. | 1410 |
| Preverco | 933 |
| Primatex Inc. | 1034 |
| Pro-Drive Fasteners | 1130 |
| Professional Coatings Inc. | 1009 |
| Proflex Products Inc. | 1312 |
| QT Sound Control (Ecore) | 720 |
| Regupol Acoustics | 626 |
| Reliance Hardwood Flooring | 207 |
| Ribadao Wood Boutique | 1401 |
| Ridgefield Wood Vents/Unity Hardwoods | 1211 |
| Roomvo | 421 |
| RT Machine Company | 844 |
| Rubberlogix | 200 |
| Rubio Monocoat USA LLC | 625 |

STO SERIES

HIGH-CAPACITY OPTIMIZED CROSS-CUT SAW SYSTEM



**STANDS OUT
FOR ITS SPEED,
ACCURACY AND
STURDY DESIGN**

**DEVELOPED
ESPECIALLY
FOR FLOORING**

**SYSTEM
INTEGRATED
IN OUR ADAPTED
SOLUTIONS**

For more than 20 years, Lico Machinery Inc. has stood out for the quality of its equipment, its adapted solutions, as well as its unique and unbeatable service. Lico specializes in the design and manufacture of sawmill and flooring equipment ranging from standalone machines to complete solutions. No compromise is made on the quality of the equipment, from design to installation, because we know that in a world where profitability depends on productivity, only quality performs.



9550 10th Avenue Industrial Park
Saint-Georges (Quebec) G5Y 8J8

418 228-3882
licoinc.net

Exhibitors

LISTED BY NAME
(as of 3.10.26)

| COMPANY NAME | BOOTH # | COMPANY NAME | BOOTH # |
|---|-------------|---|-------------|
| Sanderparts.com | 240 | Toray Plastics (America) | 605 |
| Saroyan | 1306 | Tradelink Wood Products Inc. | 520 |
| Schafer Hardwood Flooring | 213 | Tramex Moisture Meters | 825 |
| Seneca Millwork | 1012 | TRAXX Corporation | 323 |
| SGS North America | 218 | Triangulo Hardwood Floors | 1038 |
| Shaper | 216 | Trivec | 419 |
| Sheoga Hardwood Flooring | 708 | Union Tool Corporation, The | 417 |
| Sika Corporation | 516 | Unity Hardwoods | 1211 |
| SLCC Enterprise Inc. | 1321 | Urban Floor | 322 |
| SmartPlank | 830 | US Sander LLC | 1409 |
| Soest Wood Finishing Machinery | 727 | Vecoplan | 1139 |
| Solidfloor by LTL Home Products | 930 | Vermeister America Inc. | 1129 |
| Southern Winding Service Inc. | 338 | Vermont Natural Coatings | 621 |
| Springcreek Flooring | 601 | Virginia Abrasives Corp. | 709 |
| Stauf USA LLC | 924 | V-Pro | 1127 |
| Stellar Air Vents | 1234 | Wagner Meters | 1016 |
| Super Thin Saws Inc. | 1032 | WarmStep Electric Floor Heating | 639 |
| Superior Hardwood Flooring | 939 | Waterlox Coatings Corporation | 831 |
| Swiffer | 332 | WECORK | 909 |
| Taylor Adhesives | 1416 | Wickham Hardwood Flooring | 706 |
| TEKA Hardwood Flooring by PlyQuet of America Inc. | 1207 | WOCA Denmark | 1309 |
| Terra Legno | 1122 | Wood Products Manufacturers Association | 541 |
| Three Trees Flooring | 1223 | WoodTech Machines | 1104 |
| tise - The International Surface Event | 318 | WOODWISE | 1101 |
| Titebond | 911 | World Floor Covering Association | 1425 |
| Top Step Vents | 1020 | WW Flooring Group | 619 |

Ignite
YOUR PASSION



ALPINE™

- Unlimited moisture protection
- No moisture or PH testing required
- Aggressive tack, fast-grab formula
- Permanent, waterproof bond



SCAN TO
LEARN MORE



 **TAYLOR™**
ADHESIVES

An Avery Dennison Company

nwfa expo

SAVE THE DATE

FOR NETWORKING, DEMOS, EDUCATION, TRADE SHOW & MORE!

Mark your calendar now to attend next year's Wood Flooring Expo to see all the latest products and services our industry has to offer.



FORT WORTH
2027

WWW.NWFAEXPO.ORG
800.422.4556

nwfa
National Wood
Flooring Association



BAUWERK GROUP

NORTH AMERICA

Booth
301



Prestige, Oak White

One Global Group. Two Trusted Brands.
Hand crafted in North America and Europe.
Supported locally throughout the U.S.



BOEN

boen.com



somersefloors.com

MADE IN USA



ABRASIVES

| | |
|-----------------------------|------|
| Arboritec USA Inc. | 1308 |
| Berger-Seidle | 1117 |
| Bona | 901 |
| Hilltop Supply and Hardwood | 125 |
| Loba-Wakol | 133 |
| Mirka | 208 |
| Norton Abrasives | 1201 |
| Traxx Corporation | 323 |
| US Sander LLC | 1409 |
| Virginia Abrasives Corp. | 709 |

ADHESIVES

| | |
|------------------------------------|------|
| Advanced Adhesive Technologies LLC | 609 |
| Arboritec USA Inc. | 1308 |
| Berger-Seidle | 1117 |
| Bona | 901 |
| Bostik Inc. | 1001 |
| Divergent Adhesives | 926 |
| Hilltop Supply and Hardwood | 125 |
| Lastik USA | 1341 |
| Loba-Wakol | 133 |
| MAPEI Corporation | 1108 |
| PALLMANN | 1301 |
| Proflex Products Inc. | 1312 |
| Sika Corporation | 516 |
| Stauf USA LLC | 924 |
| Taylor Adhesives | 1416 |
| Titebond | 911 |
| Vermeister America Inc. | 1129 |
| WECORK | 909 |

APPLICATORS

| | |
|------------------------------------|------|
| Arboritec USA Inc. | 1308 |
| Berger-Seidle | 1117 |
| Glitsa - Lenmar, Gemini Industries | 811 |
| Lastik USA | 1341 |
| Norton Abrasives | 1201 |
| Stauf USA LLC | 924 |
| Trivec | 419 |
| Union Tool Corporation, The | 417 |
| US Sander LLC | 1409 |

BAMBOO

| | |
|-------------------------|-----|
| Penn Wood Products Inc. | 423 |
|-------------------------|-----|

BLADES AND BITS

| | |
|----------------------|------|
| CORUS Fastening | 313 |
| Gundlach Tools | 925 |
| RT Machine Company | 844 |
| Super Thin Saws Inc. | 1032 |

BORDERS/INLAYS/MEDALLIONS

| | |
|-------------------------|------|
| Penn Wood Products Inc. | 423 |
| Saroyan | 1306 |
| Seneca Millwork | 1012 |
| Shaper | 216 |
| Top Step Vents | 1020 |

BUSINESS SERVICES

| | |
|---|------|
| Centricity | 1413 |
| Gartman LLC | 339 |
| Growth Team Strategies | 1319 |
| No. Amer. Association of Floor Covering Distributors | 833 |
| Pennsylvania Lumbermens Mutual Insurance Company | 741 |
| Premiere Finishing & Coating | 613 |
| Roomvo | 421 |
| RT Machine Company | 844 |
| Wood Products Manufacturers Association | 541 |

CORK

| | |
|--------|-----|
| WECORK | 909 |
|--------|-----|

DOMESTIC WOOD FLOORING

| | |
|---|------|
| AHF Products | 631 |
| Allegheny Mountain Hardwood Flooring | 840 |
| Anthony Vandyck Inc. | 1331 |
| Appalachian Flooring Ltd. | 1100 |
| Appalachian Lumber Company | 508 |
| Armenia Mountain Plank & Panel | 835 |
| Ashawa Bay Hardwood Floors | 523 |
| Barlinek Floors | 438 |
| Bauwerk Group US/Somerset Hardwood Flooring | 301 |
| Beasley Flooring Products | 425 |
| Buchanan Hardwood Flooring Co. LLC | 1033 |
| Chelsea Plank Flooring | 202 |
| Graf Bros. Flooring | 1133 |
| Graf Custom Hardwood | 401 |
| Hardwood Solutions Inc. | 334 |
| Hassell & Hughes Lumber Co. Inc. | 733 |
| Hilltop Supply and Hardwood | 125 |
| Howell Hardwood Flooring | 539 |



ARMENIA
MOUNTAIN
plank & panel



**BEYOND
STANDARD GRADES**
see what custom really looks like

Stop by Booth 835 for a Tour

Manufactured at our facility in Troy, PA

570.995.1892

www.armeniaplank.com



DOMESTIC WOOD FLOORING, CONT.

| | |
|--|------|
| Johnson Hardwood | 738 |
| Lauzon Hardwood Floors | 622 |
| Macon Hardwood | 522 |
| Maxwell Hardwood Flooring Inc. | 517 |
| Merrick Hardwoods | 1008 |
| Mirage | 1116 |
| Missouri Hardwood Products | 317 |
| Missouri Walnut LLC | 204 |
| Mullican Flooring | 1217 |
| Ort Flooring & Lumber LLC | 325 |
| Peachey Hardwood Flooring | 1111 |
| PG Hardwood Flooring Inc. | 611 |
| Pianeta Legno Floors USA Inc. | 607 |
| Prestige Enterprise International Inc. | 1410 |
| Preverco | 933 |
| Reliance Hardwood Flooring | 207 |
| Saroyan | 1306 |
| Seneca Millwork | 1012 |
| Sheoga Hardwood Flooring | 708 |
| Springcreek Flooring | 601 |
| Unity Hardwoods | 1211 |
| Wickham Hardwood Flooring | 706 |
| WW Flooring Group | 619 |

ELECTRONICS/TECHNOLOGY

| | |
|---------------------------------|------|
| Gartman LLC | 339 |
| Landen Strapping Corporation | 839 |
| Lignomat USA Ltd. | 1125 |
| RT Machine Company | 844 |
| SmartPlank | 830 |
| WarmStep Electric Floor Heating | 639 |

END GRAIN WOOD FLOORING

| | |
|--------------------------------------|------|
| Allegheny Mountain Hardwood Flooring | 840 |
| Saroyan | 1306 |
| Seneca Millwork | 1012 |
| Triangulo Hardwood Floors | 1038 |

ENGINEERED WOOD FLOORING

| | |
|---|------|
| Aged Wide Floors | 1222 |
| AHF Products | 631 |
| Allegheny Mountain Hardwood Flooring | 840 |
| Anthony Vandyck Inc. | 1331 |
| Appalachian Flooring Ltd. | 1100 |
| Appalachian Lumber Company | 508 |
| Arboritec USA Inc. | 1308 |
| Armenia Mountain Plank & Panel | 835 |
| Ashawa Bay Hardwood Floors | 523 |
| Barlinek Floors | 438 |
| Bauwerk Group US/Somerset Hardwood Flooring | 301 |
| Beasley Flooring Products | 425 |
| D&M Flooring | 938 |
| Dreweko/T&G Wood | 311 |
| Durapalm | 1031 |
| Essex Finishing | 1041 |
| Graf Bros. Flooring | 1133 |
| Graf Custom Hardwood | 401 |
| Hilltop Supply and Hardwood | 125 |
| Howell Hardwood Flooring | 539 |
| Indusparquet USA | 441 |
| Johnson Hardwood | 738 |
| Lamont Flooring | 1126 |
| Lauzon Hardwood Floors | 622 |
| Macon Hardwood | 522 |
| Mason Wood Floors | 416 |
| Maxwell Hardwood Flooring, Inc. | 517 |
| Mirage | 1116 |
| Mullican Flooring | 1217 |
| Olde Wood Limited | 501 |
| Ort Flooring & Lumber LLC | 325 |
| Peachey Hardwood Flooring | 1111 |
| Permwood | 233 |
| PG Hardwood Flooring Inc. | 611 |
| Pianeta Legno Floors USA Inc. | 607 |
| Preverco | 933 |
| Reliance Hardwood Flooring | 207 |
| Saroyan | 1306 |
| Sheoga Hardwood Flooring | 708 |
| Solidfloor by LTL Home Products | 930 |
| Three Trees Flooring | 1223 |
| Triangulo Hardwood Floors | 1038 |
| Wickham Hardwood Flooring | 706 |



*Now Offering Prefinished & Unfinished
Premium Hardwood Floors*

True. Dependable. Reliable.

Clarion, PA



Dickson, TN

RELIANCE

hardwood flooring

615-560-0324 office

www.reliancehardwoodflooring.com

nwfa expo

2026

ORLANDO

APRIL 21-23 | NWFAEXPO.ORG

stop by

Booth 207

FACTORY-FINISHED WOOD FLOORING

| | |
|---|------|
| Anthony Vandyck Inc. | 1331 |
| Appalachian Flooring Ltd. | 1100 |
| Arboritec USA Inc | 1308 |
| Barlinek Floors | 438 |
| Bauwerk Group US/Somerset Hardwood Flooring | 301 |
| Bjelin | 1021 |
| Chelsea Plank Flooring | 202 |
| Dreweko/T&G Wood | 311 |
| Durapalm | 1031 |
| Essex Finishing | 1041 |
| Graf Custom Hardwood | 401 |
| Indusparquet USA | 441 |
| Johnson Hardwood | 738 |
| Lamont Flooring | 1126 |
| Lauzon Hardwood Floors | 622 |
| Macon Hardwood | 522 |
| Mason Wood Floors | 416 |
| Mirage | 1116 |
| Missouri Hardwood Products | 317 |
| Mullican Flooring | 1217 |
| Ort Flooring & Lumber LLC | 325 |
| Peachey Hardwood Flooring | 1111 |
| Permwod | 233 |
| PG Hardwood Flooring Inc. | 611 |
| Pianeta Legno Floors USA Inc. | 607 |
| Premiere Finishing & Coating | 613 |
| Prestige Enterprise International Inc. | 1410 |
| Preverco | 933 |
| Reliance Hardwood Flooring | 207 |
| Saroyan | 1306 |
| Seneca Millwork | 1012 |
| Solidfloor by LTL Home Products | 930 |
| Three Trees Flooring | 1223 |
| Triangulo Hardwood Floors | 1038 |
| Wickham Hardwood Flooring | 706 |
| WW Flooring Group | 619 |

FILLERS

| | |
|------------------------------------|------|
| Arboritec USA Inc | 1308 |
| Berger-Seidle | 1117 |
| Bona | 901 |
| DuraSeal | 701 |
| Glitsa - Lenmar, Gemini Industries | 811 |
| Hilltop Supply and Hardwood | 125 |
| MAPEI Corporation | 1108 |
| Vermeister America Inc. | 1129 |
| WOODWISE | 1101 |

FINISHES/COLORANTS

| | |
|--|------|
| American Sanders | 817 |
| Arboritec USA Inc | 1308 |
| Artistic Finishes Inc. | 617 |
| Basic Coatings | 808 |
| Berger-Seidle | 1117 |
| Bona | 901 |
| Canlak Coatings (PoloPlaz, Absco, & Sampson) | 717 |
| Ciranova USA Inc. | 408 |
| DuraSeal | 701 |
| Glitsa - Lenmar, Gemini Industries | 811 |
| Hilltop Supply and Hardwood | 125 |
| Horizon Forest Products | 201 |
| LED Coating Solutions by Archetypal | 531 |
| Loba-Wakol | 133 |
| MAPEI Corporation | 1108 |
| PALLMANN | 1301 |
| Penn Wood Products Inc. | 423 |
| Pianeta Legno Floors USA Inc. | 607 |
| Professional Coatings Inc. | 1009 |
| Rubio Monocoat USA LLC | 625 |
| Soest Wood Finishing Machinery | 727 |
| US Sander LLC | 1409 |
| Vermeister America Inc. | 1129 |
| Vermont Natural Coatings | 621 |
| Waterlox Coatings Corporation | 831 |
| WOCA Denmark | 1309 |

FLOATING WOOD FLOORING

| | |
|---------------------------------|------|
| AHF Products | 631 |
| Barlinek Floors | 438 |
| Dreweko/T&G Wood | 311 |
| Durapalm | 1031 |
| Indusparquet USA | 441 |
| Johnson Hardwood | 738 |
| Mirage | 1116 |
| Solidfloor by LTL Home Products | 930 |
| Triangulo Hardwood Floors | 1038 |
| WW Flooring Group | 619 |

FLOOR MANUFACTURING EQUIPMENT AND SUPPLIES

| | |
|------------------------------------|------|
| Akhurst Machinery Inc. | 1030 |
| Buchanan Hardwood Flooring Co. LLC | 1033 |
| Delmhorst Instrument Co. | 834 |
| Great Lakes Custom Tool Mfg. Inc. | 845 |
| Hasko/Mekanika | 716 |
| Landen Strapping Corporation | 839 |

Make Glitsa IDRO CLEAR™ Your GO-TO Finish

Glitsa IdroClear™ is a premium, single-component waterborne finish designed for professional results. With exceptional flow, leveling, and open time, IdroClear™ delivers a crystal-clear, even finish – even on challenging layouts. With the easy addition of the Glitsa Waterborne Hardener, Glitsa IdroClear™ becomes a powerful 2K Finish with superior durability.

- Silky Touch
- Superior Flow & Leveling
- Beautiful Clear Finish

**VISIT GLITSA.COM
TO FIND OUT MORE**



IDRO CLEAR 1K

- Self-Sealing Finish
- Easy Application



IDRO CLEAR w/ Hardener

- Full 2K durability
- Same Easy Application

**COME VISIT US AT BOOTH #811
AT NWFA EXPO IN ORLANDO**



LENMAR®

Waterborne • Conversion Varnish • Polyurethane

FLOOR MANUFACTURING EQUIPMENT AND SUPPLIES, CONT.

| | |
|-------------------------------------|------|
| LED Coating Solutions by Archetypal | 531 |
| Lico Machinery | 919 |
| NSP Panels | 1124 |
| RT Machine Company | 844 |
| Union Tool Corporation, The | 417 |
| V-Pro | 1127 |
| WoodTech Machines | 1104 |

GYM FLOORS

| | |
|---|------|
| Basic Coatings | 808 |
| Bauwerk Group US/Somerset Hardwood Flooring | 301 |
| Lauzon Hardwood Floors | 622 |
| Loba-Wakol | 133 |
| Macon Hardwood | 522 |
| Ort Flooring & Lumber LLC | 325 |
| Prestige Enterprise International, Inc. | 1410 |
| Vermont Natural Coatings | 621 |
| WECORK | 909 |
| WW Flooring Group | 619 |

IMPORTED WOOD FLOORING SPECIES

| | |
|---|------|
| AHF Products | 631 |
| Anthony Vandyck Inc. | 1331 |
| Bauwerk Group US/Somerset Hardwood Flooring | 301 |
| Dreweko/T&G Wood | 311 |
| Durapalm | 1031 |
| Indusparquet USA | 441 |
| Johnson Hardwood | 738 |
| Lauzon Hardwood Floors | 622 |
| Macon Hardwood | 522 |
| Mason Wood Floors | 416 |
| Maxwell Hardwood Flooring Inc. | 517 |
| Mullican Flooring | 1217 |
| Pianeta Legno Floors USA Inc. | 607 |
| Saroyan | 1306 |
| Seneca Millwork | 1012 |
| Three Trees Flooring | 1223 |
| Triangulo Hardwood Floors | 1038 |
| WW Flooring Group | 619 |

INDUSTRY ORGANIZATIONS

| | |
|--|-----|
| CFI - Certified Flooring Installers | 841 |
| No. Amer. Assn of Floor Covering Distributors | 833 |
| NWFA - Expo Live - <i>Hardwood Floors Magazine</i> | 801 |
| tise - The International Surface Event | 318 |
| Wood Products Manufacturers Association | 541 |

MAINTENANCE PRODUCTS

| | |
|--|------|
| American Sanders | 817 |
| Arboritec USA Inc. | 1308 |
| Basic Coatings | 808 |
| Bona | 901 |
| Canlak Coatings (PoloPlaz, Absco, & Sampson) | 717 |
| Ciranova USA Inc. | 408 |
| DuraSeal | 701 |
| Glitsa - Lenmar, Gemini Industries | 811 |
| Lignomat USA Ltd. | 1125 |
| Loba-Wakol | 133 |
| MAPEI Corporation | 1108 |
| Norton Abrasives | 1201 |
| PALLMANN | 1301 |
| Pro-Drive Fasteners | 1130 |
| Professional Coatings Inc. | 1009 |
| RT Machine Company | 844 |
| Rubio Monocoat USA LLC | 625 |
| Southern Winding Service Inc. | 338 |
| Swiffer | 332 |
| Taylor Adhesives | 1416 |
| Vermeister America Inc. | 1129 |
| Vermont Natural Coatings | 621 |
| Virginia Abrasives Corp | 709 |
| WOCA Denmark | 1309 |
| WOODWISE | 1101 |

MISCELLANEOUS TOOLS/ SUPPLIES/MOISTURE METERS

| | |
|-----------------------------------|------|
| CORUS Fastening | 313 |
| Delmhorst Instrument Co. | 834 |
| Great Lakes Custom Tool Mfg. Inc. | 845 |
| Gundlach Tools | 925 |
| Lastik USA | 1341 |
| Lignomat | 1125 |
| Mirka | 208 |
| Powernail Company | 1017 |
| Pro-Drive Fasteners | 1130 |
| Shaper | 216 |
| Super Thin Saws Inc. | 1032 |
| Tramex Moisture Meters | 825 |
| Traxx Corporation | 323 |
| Virginia Abrasives Corp | 709 |
| Wagner Meters | 1016 |
| WoodTech Machines | 1104 |

Lignomat

Moisture Meters



Proven measuring technology.
Accurate. Every time. Every day.

Measure and monitor:

- Hardwood floors
- Engineered floors
- Subfloors
- Concrete pin, pinless, in-situ RH
- Relative Humidity / Temperature



Pin-Pinless-RH-Insitu

Come and visit our booth. **1125**

See for yourself the quality and ease of usage of Lignomat meters.

We have fair and competitive prices.

Take advantage of the NWFA Show discount and save !!!!



If you could not make it to the booth, Specials are good to **May 15, 2026** with QR code.

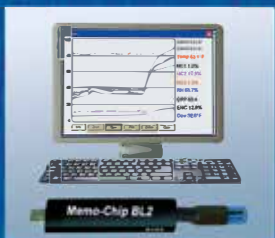

Call 800-227-2105
www.Lignomat.com

MOULDINGS/STAIR PARTS/TRIM

| | |
|---|------|
| AHF Products | 631 |
| All American Wood Register Co. | 917 |
| Anthony Vandyck Inc. | 1331 |
| Antique Building Solutions | 1408 |
| Appalachian Lumber Company | 508 |
| Artistic Finishes Inc. | 617 |
| Bauwerk Group US/Somerset Hardwood Flooring | 301 |
| CG Hardwood Molding | 321 |
| Chelsea Plank Flooring | 202 |
| Essex Finishing | 1041 |
| Grill Works Inc. | 725 |
| Hilltop Supply and Hardwood | 125 |
| L&L Hardwoods Inc. | 932 |
| Lamont Flooring | 1126 |
| Macon Hardwood | 522 |
| Mercier Wood Flooring Inc. | 700 |
| Middle Tennessee Lumber | 824 |
| Mirage | 1116 |
| NSP Panels | 1124 |
| Peachey Hardwood Flooring | 1111 |
| Penn Wood Products Inc. | 423 |
| Ridgefield Wood Vents/Unity Hardwoods | 1211 |
| Saroyan | 1306 |
| Seneca Millwork | 1012 |
| SLCC Enterprise, Inc. | 1321 |
| Traxx Corporation | 323 |
| Unity Hardwoods | 1211 |
| WECORK | 909 |

NAILERS/FASTENERS

| | |
|-----------------------------|------|
| Arboritec USA Inc. | 1308 |
| CORUS Fastening | 313 |
| Hilltop Supply and Hardwood | 125 |
| Pownail Company | 1017 |
| Primatch Inc. | 1034 |
| Pro-Drive Fasteners | 1130 |
| Traxx Corporation | 323 |
| WOODWISE | 1101 |

PARQUET/HERRINGBONE/ CHEVRON WOOD FLOORING

| | |
|---|------|
| Allegheny Mountain Hardwood Flooring | 840 |
| Anthony Vandyck Inc. | 1331 |
| Appalachian Lumber Company | 508 |
| Armenia Mountain Plank & Panel | 835 |
| Ashawa Bay Hardwood Floors | 523 |
| Barlinek Floors | 438 |
| Bauwerk Group US/Somerset Hardwood Flooring | 301 |
| Dreweko/T&G Wood | 311 |
| Essex Finishing | 1041 |
| Graf Bros. Flooring | 1133 |
| Graf Custom Hardwood | 401 |
| Lamont Flooring | 1126 |
| Lauzon Hardwood Floors | 622 |
| Macon Hardwood | 522 |
| Maxwell Hardwood Flooring Inc. | 517 |
| Mirage | 1116 |
| Mullican Flooring | 1217 |
| Peachey Hardwood Flooring | 1111 |
| Pianeta Legno Floors USA Inc. | 607 |
| Premiere Finishing & Coating | 613 |
| Preverco | 933 |
| Reliance Hardwood Flooring | 207 |
| Saroyan | 1306 |
| Seneca Millwork | 1012 |
| Sheoga Hardwood Flooring | 708 |
| Solidfloor by LTL Home Products | 930 |
| Three Trees Flooring | 1223 |
| Unity Hardwoods | 1211 |

RECLAIMED WOOD FLOORING

| | |
|--------------------------------|------|
| Antique Building Solutions | 1408 |
| Armenia Mountain Plank & Panel | 835 |
| Dreweko/T&G Wood | 311 |
| Durapalm | 1031 |
| Hilltop Supply and Hardwood | 125 |
| Macon Hardwood | 522 |
| Olde Wood Limited | 501 |
| Peachey Hardwood Flooring | 1111 |
| Pianeta Legno Floors USA Inc. | 607 |
| Premiere Finishing & Coating | 613 |
| Reliance Hardwood Flooring | 207 |
| Saroyan | 1306 |

RESTORATION EQUIPMENT

| | |
|--------|------|
| Mirka | 208 |
| Shaper | 216 |
| V-Pro | 1127 |

RECLAIMED
and
BESPOKE BUILDING MATERIALS

ANTIQUE

BUILDING SOLUTIONS

ESTD. *Howard, Pennsylvania* 1998

FLOATING
TREADS
THAT TURN
HEADS.

WWW.ANTIQUEBUILDINGSOLUTIONS.COM

nwfa
National Wood
Flooring Association

SANDING EQUIPMENT

| | |
|-------------------------------|------|
| Akhurst Machinery Inc. | 1030 |
| American Sanders | 817 |
| Arboritec USA Inc. | 1308 |
| Basic Coatings | 808 |
| Bona | 901 |
| Hilltop Supply and Hardwood | 125 |
| Mirka | 208 |
| PALLMANN | 1301 |
| Southern Winding Service Inc. | 338 |
| Trivec | 419 |
| US Sander LLC | 1409 |
| Virginia Abrasives Corp. | 709 |
| WoodTech Machines | 1104 |
| WOODWISE | 1101 |

SOFTWARE, INSTALLATION MGT.

| | |
|-------------|------|
| Gartman LLC | 339 |
| JobTread | 1317 |

SPECIALTY WOOD FLOORING

| | |
|---|------|
| Allegheny Mountain Hardwood Flooring | 840 |
| Barlinek Floors | 438 |
| Bauwerk Group US/Somerset Hardwood Flooring | 301 |
| Dreweko/T&G Wood | 311 |
| Durapalm | 1031 |
| Essex Finishing | 1041 |
| Graf Custom Hardwood | 401 |
| Hilltop Supply and Hardwood | 125 |
| Indusparquet USA | 441 |
| Macon Hardwood | 522 |
| Mason Wood Floors | 416 |
| Maxwell Hardwood Flooring Inc. | 517 |
| Olde Wood Limited | 501 |
| Peachey Hardwood Flooring | 1111 |
| Pianeta Legno Floors USA Inc. | 607 |
| Premiere Finishing & Coating | 613 |
| Prestige Enterprise International, Inc. | 1410 |
| Reliance Hardwood Flooring | 207 |
| Saroyan | 1306 |
| Seneca Millwork | 1012 |
| Shaper | 216 |
| Solidfloor by LTL Home Products | 930 |
| Triangulo Hardwood Floors | 1038 |

SUBFLOORS

| | |
|---------------------------|------|
| Bostik Inc. | 1001 |
| Lignomat USA Ltd. | 1125 |
| Loba-Wakol | 133 |
| MP Global Products LLC | 1029 |
| Ort Flooring & Lumber LLC | 325 |

SUBFLOORS, CONT.

| | |
|--|------|
| PALLMANN | 1301 |
| Prestige Enterprise International Inc. | 1410 |
| Proflex Products Inc. | 1312 |
| Regupol Acoustics | 626 |
| Sika Corporation | 516 |
| Stauf USA LLC | 924 |
| Taylor Adhesives | 1416 |
| Vermeister America Inc. | 1129 |
| Wagner Meters | 1016 |

UNDERLAYMENTS

| | |
|---|------|
| Barlinek Floors | 438 |
| Bostik Inc. | 1001 |
| Fortifiber Flooring Products | 1335 |
| Hilltop Supply and Hardwood | 125 |
| Jackson Building Products | 1123 |
| Laticrete International, Inc. | 1025 |
| Loba-Wakol | 133 |
| MAPEI Corporation | 1108 |
| MP Global Products LLC | 1029 |
| Prestige Enterprise International, Inc. | 1410 |
| Proflex Products Inc. | 1312 |
| QT Sound Control (Ecore) | 720 |
| Regupol Acoustics | 626 |
| Sika Corporation | 516 |
| SLCC Enterprise, Inc. | 1321 |
| Toray Plastics (America) | 605 |
| Traxx Corporation | 323 |
| WarmStep Electric Floor Heating | 639 |
| WECORK | 909 |

VENTS

| | |
|---------------------------------------|------|
| All American Wood Register Co. | 917 |
| Artistic Finishes Inc. | 617 |
| CG Hardwood Molding | 321 |
| Essex Finishing | 1041 |
| Grill Works Inc. | 725 |
| Hilltop Supply and Hardwood | 125 |
| Macon Hardwood | 522 |
| Mercier Wood Flooring Inc. | 700 |
| Peachey Hardwood Flooring | 1111 |
| Penn Wood Products Inc. | 423 |
| Ridgefield Wood Vents/Unity Hardwoods | 1211 |
| Seneca Millwork | 1012 |
| Shaper | 216 |
| Sheoga Hardwood Flooring | 708 |
| Stellar Air Vents | 1234 |
| Top Step Vents | 1020 |
| Triangulo Hardwood Floors | 1038 |



Top Step Vents

DECORATIVE FLUSH MOUNT
METAL VENTS



ALSO AVAILABLE:



DIY VENT SOLUTIONS



CUSTOM SIZES

WHAT CAN NWFA DO FOR YOU?



REAL MEMBERS. REAL RESULTS.

"THE NWFA has been such a valuable resource for me and my career. THE HANDS-ON TRAINING helped solidify all the things that I actually was doing right. The NWFA COMPLETELY CHANGED THE ENTIRE TRAJECTORY OF MY LIFE."

— ALEX HAMILTON, Grain Design Flooring
2025 NWFA Wood Floor of the Year Members' Choice Winner

Being a wood flooring professional has never been more complicated than it is today. There is a lot of uncertainty out there impacting your business. One thing that remains certain is NWFA's commitment to you and your company. The NWFA is expanding and implementing products and services that can help your business thrive.



SCAN TO JOIN

Join NWFA Today!



NATIONAL WOOD FLOORING ASSOCIATION
NWFA.ORG | 800.422.4556

For more details, visit
[NWFA.ORG/MEMBERSHIP/](https://www.nwfa.org/membership/)



THE FUTURE OF WOOD SURFACE FINISHING IS HERE

High-Performance, Cutting-Edge LED Curing
Technology for the Wood Finishing Industry



See for yourself at **Booth #531**



by



Learn more at ledcoatingsolutions.com | Contact: office@ledcoatingsolutions.com

  @ledcoatingsolutions

Exhibitor SHOWCASE



ALLEGHENY MOUNTAIN HARDWOOD FLOORING

Booth 840

Rift and quartersawn Allegheny Mountain Hardwood Flooring Red Oak delivers straight, striking grain with smaller medullary rays, exceptional stability, and versatility from rustic to modern. Sourced from tight-growth northern Appalachian forests, it costs less than white oak yet stains beautifully and performs over radiant heat – letting contractors boost margins while offering clients premium performance and aesthetic.

hickmanwoods.com



ANTIQUE BUILDING SOLUTIONS

Booth 1408

Deeply rooted in American heritage, our reclaimed white oak floating treads are salvaged from 19th-century barns to bring history home. Available in 2" to 4" thicknesses – as solid timber or dual-piece glue-ups – each tread showcases centuries of slow-growth grain and storied patina. Can come nude or prefinished.

antiquebuildingsolutions.com



APPALACHIAN LUMBER COMPANY

Booth 508

Producing engineered and solid plank flooring, mouldings, stair parts, treads, risers, box newels, handrails, and more. Specializing in the unique and hard-to-find. Stocking more than 20 species, with inventory of many stock items. Give us an opportunity on your next special hardwood job.

appalachianlumber.net



ARMENIA MOUNTAIN PLANK & PANEL

Booth 835

Custom wide plank engineered and solid flooring – precision milled “One Plank at a Time” at our facility in Troy, Pennsylvania. Our customer-focused approach, perfect-fit milling, and glued plywood T&G joint for superior stability make us a trusted partner you can rely on. We offer capabilities to suit a variety of design needs, including: widths up to 12”, herringbone and chevron patterns, and three-layer balanced construction.

armeniaplank.com



IGNITE YOUR PASSION

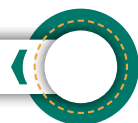

Our Rift & Quartered Red Oak is crafted from premium Northern Appalachian hardwoods, precision milled with consistent grading and long lengths. It delivers the clean, linear look your customers want — with the warm undertones making a strong comeback.

Offer a beautiful alternative to costly white oak. Save your clients money, improve your margins, and give your crews an easier install with flooring built for performance.

@hickmanwoods



RIFT & QUARTER SAWN

RED OAK

*BY ALLEGHENY MOUNTAIN
HARDWOOD FLOORING*

501 Main St. Emlenton, PA 16373

www.hickmanwoods.com | 724.867.9441

@hickmanwoods | 100% FSC Certified PA Hardwoods



Exhibitor SHOWCASE



BERGER-SEIDLE

Booth 1117

AquaSeal® GreenStar by Berger-Seidle® is a premium, two-component, waterborne polyurethane finish that delivers outstanding durability and workability. Free of isocyanates, aziridine, and hazard labeling, AquaSeal® GreenStar represents a new generation of environmental, user, and health protection. With its 18-hour pot life and high chemical resistance, AquaSeal® GreenStar sets new standards in high-performance wood floor finishing.

berger-seidle.com

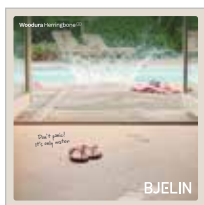

BJELIN

Booth 1021

Bjelin's Woodura Herringbone 3.0 combines high-quality FSC®-certified Croatian oak with smart, innovative engineering to create a more durable, eco-friendly floor. Herringbone is a timeless choice that adds character and elegance to any space – a stylish flooring option you can feel good about.

bjelin.com



BONA

Booth 901

Bona is the foundation of beautiful hardwood floors around the world. The Bona System works in synergy to deliver consistent, high-quality results every time. We didn't just create the first complete system for hardwood flooring professionals, we defined it. Visit Bona at Booth #901 to learn how our system can elevate your projects.

bona.com



BRUCE®, A BRAND OF AHF PRODUCTS

Booth 631

Bruce® Natural Choice™ is real solid hardwood that installs easily with SUMMIT™ SELECT, a pioneering glue-down adhesive. Offered in 2¼" and 3¼" widths, it provides flexible design options. Made in the U.S.A., this 5/16" low-profile flooring delivers timeless wood beauty, durable performance, and modern installation advantages.

bruce.com



IGNITE YOUR PASSION



Woodura Herringbone ^{3.0}

HERRINGBONE FLOOR MADE FOR *real life*

Don't panic!
It's only water.



72h

WATER
PROOF



Discover more at →

us.bjelin.com

BJELIN

Exhibitor SHOWCASE



CANLAK COATINGS

Booth 717

Absco RED X Pro Red Blocker is a one-step waterborne formula designed to block the red and pink tones of certain wood species, especially red oak, to help mimic the look of white oak flooring. RED X Pro is not a bleach, but a low-odor, quick-drying water-based formula that can be used as a blocker to help achieve lighter wood tones and is compatible with all Absco products. RED X Pro works with many red-toned wood species such as red oak or cherry.

canlakcoatings.com



CORUS FASTENING

Booth 313

Lightweight. Powerful. Reliable. The CORUS BCSS0-R 15-1/2 Flooring Stapler features tool-free depth adjustment, non-marring urethane roller system, fast magazine loading, and ergonomic comfort at just nine pounds.

corusfastening.com



DELMHORST

Booth 834

The JX-20 and JX-30 meters offer a professional-grade, accurate, and versatile tool to flooring professionals and inspectors to address moisture issues and perform your job with complete confidence. The JX-30 features connectivity to the Delmhorst EDGE® app with expanded wood species, customizable settings, and the ability to share data from any location.

delmhorst.com



DENALI HARDWOOD FLOORS

Booth 331

The Mason Collection offers three thoughtfully curated colors, including Arcade, each expressing the rustic beauty of European Oak. Nature+grading reveals authentic knots and tonal variation for a warm, lived-in feel. With 8 $\frac{1}{2}$ " wide planks, $\frac{5}{8}$ " thickness, and a 4mm sawn veneer, it delivers lasting stability for residential and light commercial spaces.

denalihardwoodfloors.com



IGNITE YOUR PASSION

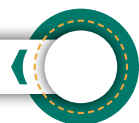

FOR A CLEAN, NATURAL LOOK, GRAND CLEAR 1K DELIVERS.

Today's customers want floors that stay true to the wood. Clear. Natural. Modern.

Absco Grand Clear 1K is a Non-Yellowing, single-component finish that keeps floors looking clear over time while delivering long-lasting protection.

Easy to apply. Easy to manage. Built for contractors who want fewer headaches and fewer callbacks.

- Non-Yellowing finish that stays clear over time
- Single-component simplicity with professional-grade durability
- Easy application that helps reduce costly callbacks



FINISH
WITH CONFIDENCE.



Exhibitor SHOWCASE



DURAPALM BY SMITH & FONG

Booth 1031

Durapalm flooring is crafted from plantation-grown palm wood, offering bold linear grain, rich natural variation, and a distinctly tropical character. Dense and durable, it provides a renewable alternative to traditional hardwoods for residential, hospitality, and commercial interiors seeking warmth, texture, and something truly unique.

durapalm.com



ESSEX FINISHING

Booth 1041

Essex's untraditional approach is aimed at offering a wide range of custom hardwood flooring. Our factory in New Jersey is specially designed for complex niches and small runs. Featured here is faded grey, an in-house smoked, wire-brushed, and hand-stained European Oak available in both prime and character grades.

essexandco.com



GAMETIME COATINGS

Booth 1239

GameTime Phoenix is a premium two-component water-based coating with an eight-hour pot life. Phoenix was engineered for consistent results and ease of application. Available in four sheens, Phoenix has what you need for even your most particular customer. Reach out today to get in the Game.

gametimecoatings.com



GLITSA - LENMAR, GEMINI INDUSTRIES

Booth 811

No crosslinker required – Idro Clear™ uses oxidative curing to achieve a durable, chemically resistant film. This single-component waterborne finish provides excellent flow, uniform leveling, and rapid recoat times. Available in satin or matte, Idro Clear delivers consistent film build, strong scratch resistance, and efficient application for professional wood flooring workflows.

glitsa.com



GROWTH TEAM STRATEGIES

Booth 1319

We are a business consulting and coaching company focusing on the wood flooring industry and a proud and active member of NWFA. The company specializes in growth planning, process improvement, profit enhancement, and succession planning. Our custom “GRASP” process is designed as a six-month engagement to develop a five-year plan.

growthteams.com

Uniquely beautiful, highly durable palm wood flooring for commercial and residential interiors.

durapalm®

by SMITH & FONG®

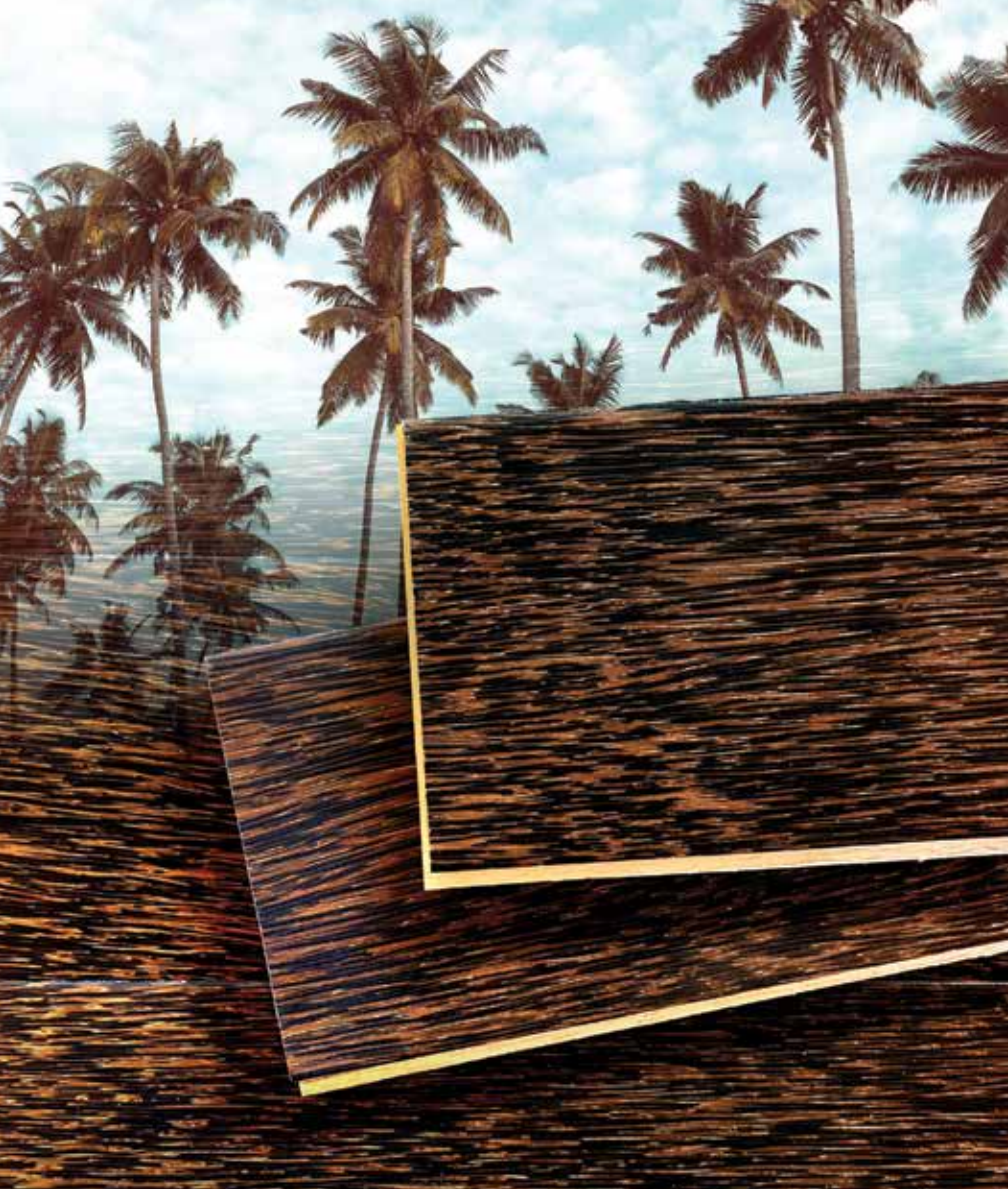

VISIT US AT BOOTH 1031

durapalm.com

Exhibitor SHOWCASE



HILLTOP SUPPLY AND HARDWOOD

Booth 125

Revolutionize your work with I-4 Wood: the counter-rotating four-head planetary sander designed for outstanding performance on all hardwood surfaces. Equipped with a powerful 3.5 or 4 HP motor, I-4 Wood combines versatility, power, and ease-of-use. Contact Hilltop Supply and Hardwood to purchase today.

hilltopky.com



HORIZON FOREST PRODUCTS

Booth 201

Your one-stop-shop for: Unfinished flooring and prefinished flooring. **INSTALLATION PRODUCTS:** Adhesives, moisture protection, underlayment, protective overlays, nailers, large machines, small machines. **FINISHING PRODUCTS:** Abrasives, stains, water-based finish, oil-based finish, filler, finishing touches, vents, medallions, moulding. 1,000s of SKUs | 22 Locations | 750,000+ square feet of warehouses.

horizonforest.com



LED COATING SOLUTIONS

Booth 531

Vesting and Heidelberg LED-cured hardwax oils with satin, matte, gloss, semi-gloss, and ultra-matte sheens. Innovative and high-performance finishes designed for flooring, these LED-cured hardwax oils offer instant curing under LED light. They provide durable, eco-friendly protection with zero VOC emissions, enhancing the natural beauty of wood with a smooth, water- and chemical-resistant finish with unlimited color options. Suitable for factory and on-site applications.

ledcoatingsolutions.com



LICO MACHINERY

Booth 919

For more than 25 years, Lico Machinery Inc. has stood out for the quality and reliability of its equipment, the flexibility of its adapted solutions, and its unmatched dedication to customer service. Lico specializes in the design and manufacture of wood flooring equipment ranging from standalone machines to complete solutions.

licoinc.net



LIGNOMAT

Booth 1125

The Ligno-VersaTec is our best meter for floor installers and inspectors. It can be used as a pin and pinless meter or as a RH-insitu humidity-concrete meter. We offer the pinless dual-depth Ligno-VersaTec meter by itself or complete measuring kits V2-M up to V24-KM. Accuracy and dependability are guaranteed with smart design and quality manufacturing.

lignomat.com

UNLEASH THE POWER OF THE I-4 WOOD



*PUSH YOUR BUSINESS
FURTHER WITH THE
FASTEST, MOST
POWERFUL PLANETARY
ON THE MARKET WITH
THE FINEST SCRATCH
PATTERN.*

TEST DRIVE
AT BOOTH
#125

CALL TO ORDER! 859-240-4157



[®]
HYPER
GRINDER

Exhibitor SHOWCASE



LOBA-WAKOL

Booth 133

LOBA Stain: Achieve rich, even color in just one hour with no lap marks and no hassle. Safe, easy to apply, and compatible with Loba water-based finishes, it's the perfect stain made simple for a perfect installation. Available in more than 20 colors.

loba-wakol.com

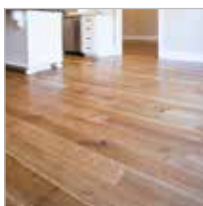

MAXWELL HARDWOOD FLOORING

Booth 517

Maxwell Hardwood Flooring manufactures Legacy Flooring which is our premium line of white oak plank floors that includes a rift and quartered floor as well as a live sawn floor. Legacy Reserve and Legacy Live are available in unfinished $\frac{3}{4}$ " solid and $\frac{5}{8}$ " engineered.

maxwellhardwoodflooring.com



MEKANIKA/HASKO

Booth 716

Our fully automated robotic flooring nester is a unique engineering solution that integrates seamlessly into your process. It modernizes your production line with real-time monitoring and SQL connectivity, ensures consistent performance, strengthens your innovative image, and guarantees every package reflects your commitment to quality and excellence.

mekanika.net



NOFMA

Booth 801

Through the years, NOFMA standards have stood the test of time. NOFMA has been certifying hardwood flooring since 1907 and is the only standard in the industry that assures flooring has been properly kiln dried, manufactured, and graded.

nwfa.org/manufacturing/



NWFA

Booth 801

The National Wood Flooring Association (NWFA) represents all segments of the hardwood flooring industry. NWFA's mission is to unify and strengthen the wood flooring community through technical standards, education, networking, and advocacy. This is accomplished through various programs and services, such as hands-on and online training, our annual Expo, *Hardwood Floors* magazine, and technical standards and publications that are recognized worldwide.

nwfa.org

MAXWELL[®] HARDWOOD FLOORING

FAMILY OWNED & OPERATED SINCE 1992

MADE IN AMERICA AND TRUSTED FOR GENERATIONS.

**Crystal Bridges Museum of American Art, Bentonville, AR | MHF 3/4" x 2 1/4" Clear Red Oak*

When you choose one of our solid floors, you're choosing products grown in American soil and manufactured with American pride. That's more than just a slogan, it's a shift. It's a place where machines wake up before the sun does, where our products carry the fingerprints of our people who craft them, and they know how to make things that last through the generations.

So as our country heads toward its 250th anniversary, we not only honor our history and those who built this country, but we also celebrate the hardworking people like ours, who are building our future, and everyone at our company wants you to know, this isn't just flooring... it's our story and a piece of the country you call home.



www.maxwellhardwoodflooring.com

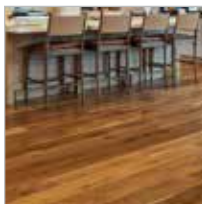

OLDE WOOD LTD.

Booth 501

European mountain oak captures the refined, dark-toned floors of 17th-century European elite homes. Live sawn from mature wood, these wide planks showcase rich brown tones and distinct sapwood alongside the full range of the wood's natural character – tight grain patterns, saw marks, sound knots, and natural checking.

oldewoodltd.com



PALLMANN

Booth 1301

NEXUS-FUSION is a one-component, solvent- and water-free Silane-Terminated Polymer (STP) adhesive designed for hardwood floors. It offers sound dampening and moisture control of up to 95 percent, reducing the risk of adhesion failure. Experience efficient installation, longer working times, and simple cleanup.

us.pallmann.net



PEACHEY HARDWOOD FLOORING

Booth 1111

Peachey reclaimed is sourced from antique barns and buildings that have been dismantled carefully to maintain as much of the original character as possible, showcasing all characteristics of old buildings that just can't be reproduced with new lumber. Each board carries the unique nail holes, worm holes, mortise and tenon joints, and natural patina.

peacheyhardwoodflooring.com



PIANETA LEGNO FLOORS USA

Booth 607

Pianeta Legno Floors U.S.A. Inc. offers the finest selection of engineered hardwood flooring. We provide custom finishing in our Miami, Florida facility to accommodate all of your wood flooring needs. With more than 300 finish options in European white oak and exotic species, we support large-volume production, in-stock programs, and offer private labeling opportunities.

italianwoodfloors.com



RELIANCE HARDWOOD FLOORING

Booth 207

Herringbone Hardwood Flooring – a floor pattern requiring exact manufacturing to create the unique and beautiful look of herringbone. Offered in white oak, red oak, and hickory. $\frac{3}{4}$ " solid or engineered, unfinished $2\frac{1}{4}$ ", $3\frac{1}{4}$ ", 4", 5", 6" 7", and 8" widths. Custom lengths may be specified based on desired pattern.

reliancehardwoodflooring.com



PIANETA™ LEGN O

FLOORS USA, INC.

www.ItalianWoodFloors.com

6405 Biscayne Boulevard Miami, FL, 33138

P: (305)-576-3141 | F: (305)-576-3151

e-mail: info@plfloors.com

 [pianeta_legno](https://www.instagram.com/pianeta_legno)



PROUD MEMBER OF



nwfa expo

2026 ORLANDO

APRIL 21-23 | NWFAEXPO.ORG

Meet us at Booth #607

nwfa
National Wood
Flooring Association
MEMBER

Exhibitor SHOWCASE

HERRINGBONE

CHEVRON

SHEOGA HARDWOOD FLOORING

Booth 708

Herringbone and chevron patterns require exceptional precision – many contractors cut them on-site to avoid mismatched joints. At Sheoga, our advanced milling technology and slow, careful production ensure perfect angles, consistent dimensions, and flawless alignment. Trust our expertise to deliver factory-crafted herringbone and chevron flooring with superior accuracy and craftsmanship every time.

sheogaflooring.com



STAUFA USA

Booth 924

PUM-950 Power-Mastic® is a high-strength, urethane-based wood flooring adhesive engineered for professional installation. Free of isocyanates and solvents, it delivers exceptional shear strength, long open time, and strong green grab without flash time. Its non-slump formula ensures reliable transfer and consistent performance on demanding hardwood projects.

staufusa.com



SWIFFER

Booth 332

Mop smarter with Swiffer PowerMop Wood, an all-in-one mopping system that gives you a mop and bucket clean in half the time*. The pad has more than 300 Gentle-Glide strips that absorb dirt and grime – even in grooves and grout. The lemon scented QuickDry cleaning formula dries up to 2X faster**.

**vs. mop and bucket - includes cleaning and drying time*

***vs. Mr. Clean All Purpose Cleaner*

swiffer.com



TAYLOR ADHESIVES

Booth 1416

Ridgeline leads the industry with unmatched protection for wood floors. It creates an unlimited moisture vapor barrier, resists alkalinity, and significantly reduces impact and sound transmission. With no moisture-related testing required, Ridgeline streamlines installation, saving time and money while delivering superior performance.

tayloradhesives.com



TISE - THE INTERNATIONAL SURFACE EVENT

Booth 318

The International Surface Event (tise) 2027 is where the surfaces industry unites to kick off the year. Discover trends, styles, and innovations shaping 2027, connect with industry leaders, and explore an enhanced experience designed to inspire and deliver results. Two neighborhoods. One event. All angles covered.

intlsurfaceevent.com

STAUF[®]

— EST. 1828 —

SOLVA-MASTIC[®]
WFR930

**No Hollow Spots.
Effortless Cleanup - No Etching.
Unmatched Strength.**

Stick With What Works



www.staufusa.com



TOP STEP VENTS

Booth 1020

Our decorative flush-mount vents are crafted from durable ¼" steel and designed to sit perfectly level with your floor. Made to stand out, they add a bold, finished look to solid and engineered wood flooring. Proudly manufactured in Utah, each vent combines quality craftsmanship with modern, eye-catching design.

topstep.biz



UNION TOOL CORPORATION, THE

Booth 417

This system includes our core board feeder, hot melt roller coater, lay-up conveyor, rotary laminator, and flying cutoff saw. Our hot melt roller coater applies a uniform coating of PUR adhesive to plywood cores. Thin lamellas are placed on top of the coated cores before they are laminated together using the rotary laminator. Boards then are cut to specific lengths by our flying cutoff saw.

uniontoolcorp.com



WAGNER METERS

Booth 1016

Floor Sentry, the embedded wood floor data logger, monitors wood floor and subfloor temperature and relative humidity conditions through its Bluetooth connection with the Wagner Sentry app. Monitor real-time data, receive instant alerts for threshold breaches, effortlessly share detailed reports, and maintain precise control over your wood floor and subfloor environments.

wagnermeters.com



WOODWISE

Booth 1101

WOODWISE is showcasing its extensive line of wood fillers, maintenance products, and tools and accessories for the wood flooring industry. Experienced Woodwise reps will be on hand to help answer all of your questions and provide product demos throughout the NWFA Expo. Available throughout North America.

woodwise.com

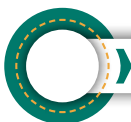

IGNITE YOUR PASSION





THE
**UNION TOOL
CORPORATION**



COMPLETE

ENGINEERED FLOORING LAMINATION SYSTEMS

MAXIMIZE PRODUCTION OUTPUT WHILE MAINTAINING PRECISION QUALITY CONTROL



We offer our engineered flooring lamination system in a variety of different sizes



Single lane or dual lane options for specific production requirements



Configurations for piece by piece or continuous types of laminations

VISIT US AT NWFA BOOTH #417

Floorplan

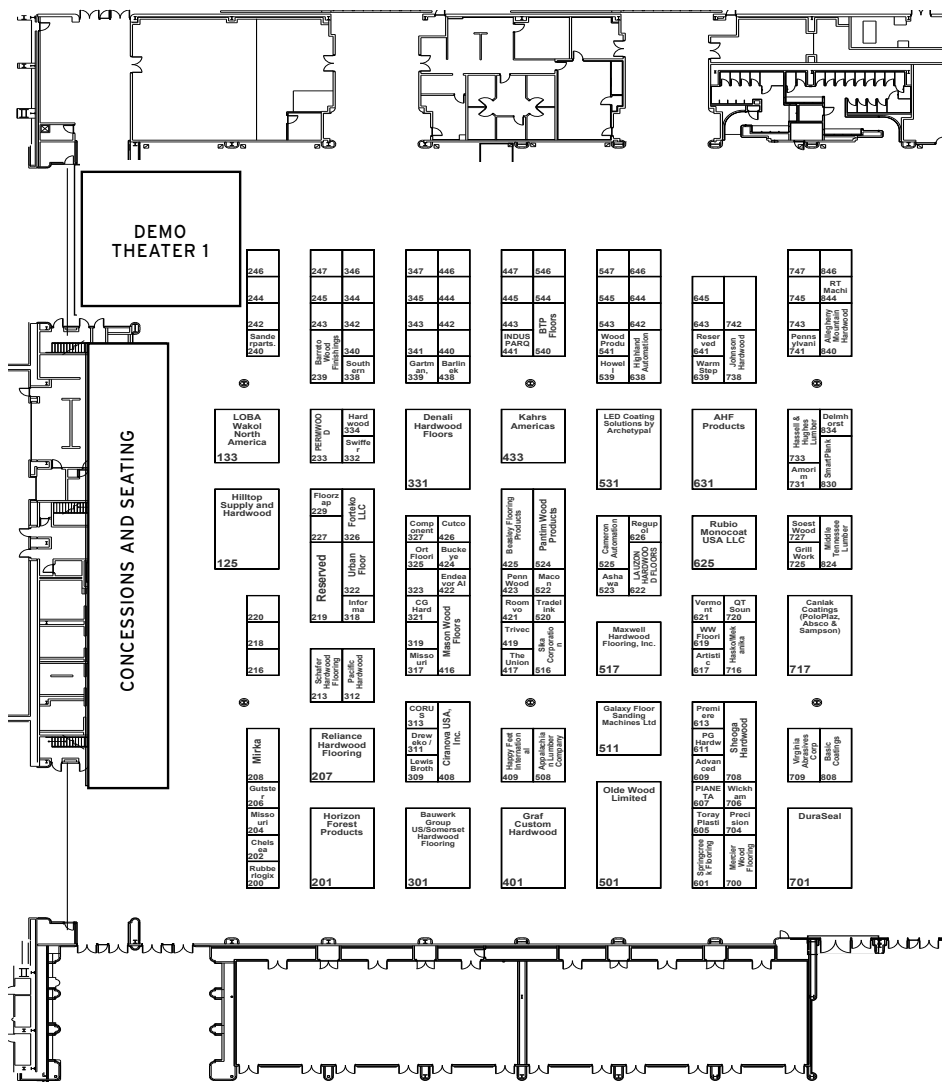

THANK YOU
TO OUR
MOBILE APP
SPONSORS

Bona[®]
SEE US AT BOOTH #901

MULLICAN[®]
— HARDWOOD FLOORING —
SEE US AT BOOTH #1217

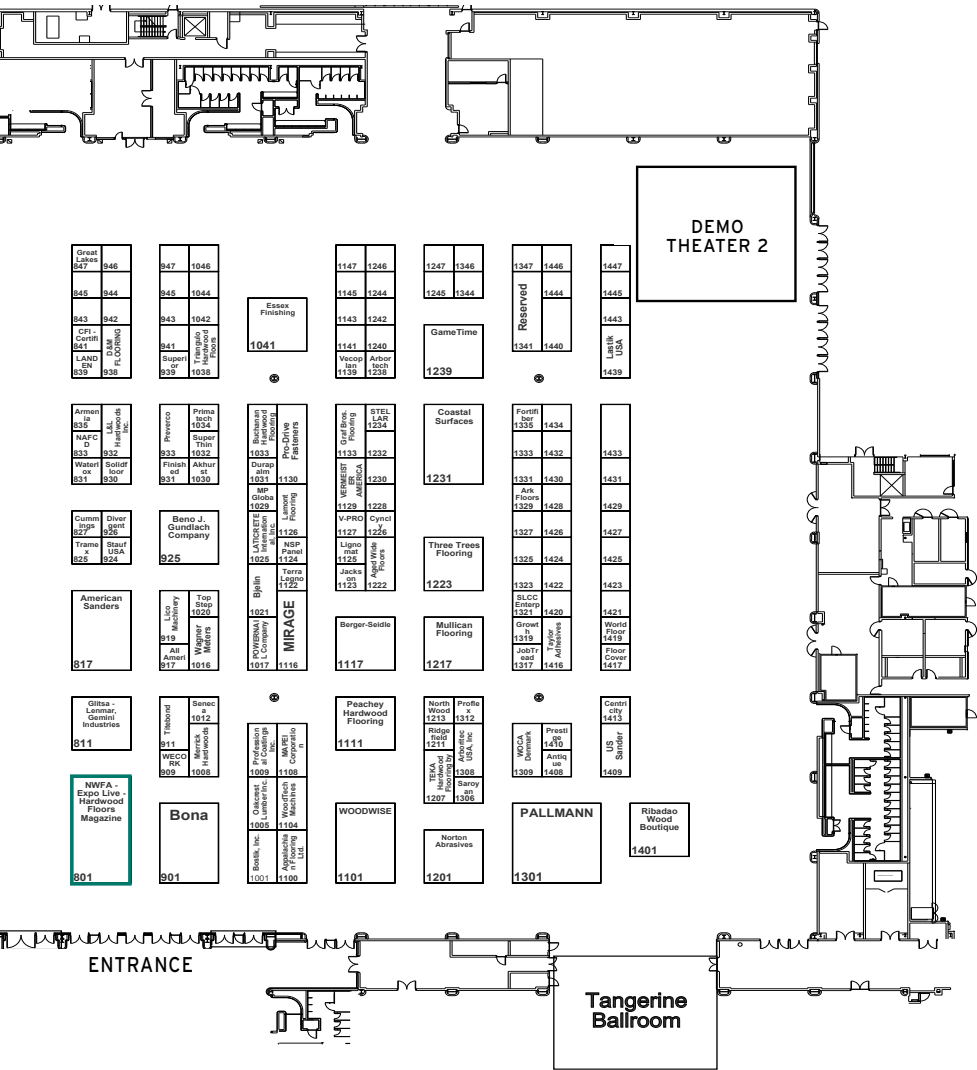

FLOOR PLAN ALSO AVAILABLE ON THE NWFA EXPO APP:

Download the 2026 Mobile App from iTunes or Google Play.

Sightseeing

IN THE SUNSHINE STATE

Everyone knows about Florida's beaches and Orlando's theme parks. Here, local NWFA members offer additional recommendations of what to see and do should you decide to add on some days to your Expo trip.

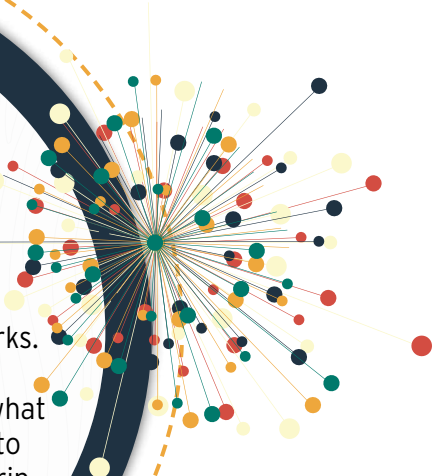

PHOTOS COURTESY OF ADOBE

“Try to make it to [Cape Canaveral](#) on the Space Coast.”

- *Bob Goldstein, Vermont Natural Coatings*

“Since we are in theme park central, any park is a good option. If you are into historic sites, a day trip to St. Augustine is good. Beaches on either side of the peninsula are waiting for you. There also are

loads of [scuba and snorkling sites](#) on the east coast.

Plus, we have flat boat fishing and deep-sea fishing opportunities.”

- *Lenny Hall, Endurance Floor Company Inc.*



“If someone is a history buff, rent a car and go to [St. Augustine](#), since it's the oldest city in our nation. If you just want to spend time with the kids, then you're in the perfect place in Orlando to go to Disney or Universal Studios.”

- *Andy Campbell, DNA Floor Surgeons Inc.*



“A visit to NASA/Kennedy Space Center. [Universal Studios Orlando's Epic Universe](#) (ideally with express passes because the lines for the rides can be one hour or more). Take an air boat ride, which always is a unique way to see Florida's natural wetlands.”

- *Rob Mercier, Walk on Wood Inc.*

THANK YOU TO THE FOLLOWING PARTNERS FOR ADVERTISING WITH US.

| | | | |
|--|----|--|--------|
| Allegheny Mountain Hardwood Flooring | 47 | Lico Machinery | 27 |
| Antique Building Solutions | 41 | Lignomat | 39 |
| Appalachian Lumber Co. | 23 | Loba-Wakol | 13 |
| Armenia Mountain Plank & Panel | 33 | Maxwell Hardwood Flooring Inc. | 57 |
| Bauwerk Group North America | 31 | NOFMA | IBC |
| Berger-Seidle | BC | NWFA..... | 30, 44 |
| Bjelin | 49 | Olde Wood Limited | IFC |
| Bona US | 5 | Pallmann | 1 |
| Bruce®, a brand of AHF Products | 19 | Peachey Hardwood Flooring | 7 |
| Canlak Coatings | 51 | Pianeta Legno Floors USA Inc. | 59 |
| CORUS Fastening | 4 | Reliance Hardwood Flooring | 35 |
| Delmhorst Instrument Co. | 25 | STAUF USA | 61 |
| Durapalm by Smith & Fong | 53 | Swiffer | 11 |
| Essex Finishing | 9 | Taylor Adhesives | 29 |
| GameTime Coatings | 6 | tise - The International Surface Event | 22 |
| Gemini Industries | 37 | Top Step Vents | 43 |
| Growth Team Strategies | 8 | Union Tool Corporation, The | 63 |
| Hilltop Supply and Hardwood | 55 | Wagner Meters | 17 |
| Horizon Forest Products | 15 | Woodwise | 2 |
| LED Coating Solutions by Archetypal | 45 | | |

INTERESTED IN ADVERTISING WITH **HARDWOOD FLOORS** MAGAZINE?

Contact *Hardwood Floors*
magazine today or visit
hardwoodfloorsmag.com
to learn more.



Katie Schenk
Advertising & Brand Growth Director
katie.schenk@nwfa.org
314.488.4669

TRUSTED

Across the Land

Quality Made.
Close to home.



TRUSTED MANUFACTURERS

- AHF Products
- Anthony Oak Flooring
- Appalachian Lumber Co.
- Bluegrass Wood Products
- Buchanan Hardwoods / Elite Brand Flooring
- Carlisle Wide Plank Floors
- Carroll Hardwood Co.
- Chelsea Plank Flooring by Frame Industries, Inc.
- Cumberland Lumber & Mfg.
- Graf Custom Hardwood
- Hassell & Hughes Lumber Co.
- Henry County Hardwoods
- Lauzon Flooring
- Lewis Brothers Lumber Co.
- Maine Traditions Flooring / WW Flooring Group
- Maxwell Hardwood Flooring
- Merrick Hardwoods
- Middle TN Lumber Co.
- Missouri Hardwood / Hardwoods of Missouri
- Mullican Flooring
- Ouachita Hardwood Flooring
- Premier Hardwood Products
- Reliance Hardwood Flooring
- Roberts Wood Products
- Sheoga Hardwood Flooring
- Smith Flooring Inc.
- Somerset Hardwood Flooring
- Superior Hardwood Flooring by Herwynen Saw Mill Ltd.
- T&F Lumber Co.



100 YEARS AND COUNTING

NOFMA members are located in the U.S. and Canada.



SUSTAINABLE AND SAFE

Trust that your floors are safe, sustainable, and sound.



SETTING THE INDUSTRY STANDARD

NOFMA assures wood flooring has been properly kiln dried, manufactured, and graded.

BECOME NOFMA CERTIFIED

Join the network

WHEN QUALITY MATTERS,
CONTACT AN NWFA/NOFMA MANUFACTURER.

NWFA.ORG/MANUFACTURING/ • 800.422.4556



VIEW MORE

1926 – 2026

Together for **YOU**
Together with

THANK YOU FOR
100
YEARS
OF PASSION FOR
WOOD FLOORING

100
YEARS | **bergerseidle**[®]

Meet us at Booth #1117

nwfa expo

2026

ORLANDO

APRIL 21-23 | NWFAEXPO.ORG